

CITY OF RICHMOND, VIRGINIA

DEPARTMENT OF PUBLIC WORKS

TRANSPORTATION ENGINEERING DIVISION



2022 REPAVING BIKE LANE PROJECTS (2 CORRIDORS)

ADMIRAL STREET / SCHOOL STREET
FROM LOMBARDY STREET TO CHAMBERLAYNE AVENUE
PROJECT # XXXXXX , AWARD # XXXXXX

REVISIONS

NO.	DATE	COMMENTS

CITY OF RICHMOND

APPROVED FOR CONSTRUCTION

DATE	SURVEYS SUPERINTENDENT
DATE	PROJECT MANAGER
DATE	MAINTENANCE ENGINEER
DATE	CITY TRANSPORTATION ENGINEER
DATE	CAPITAL PROJECTS ADMINISTRATOR
DATE	CITY ENGINEER
DATE	DIRECTOR OF PUBLIC WORKS

INDEX OF SHEETS

SHEET TITLE

- TITLE SHEET
- QUANTITIES / DETAILS
- EXISTING CONDITIONS PLAN
- PROPOSED CONDITIONS PLAN

SHEET NO.

- 1
- 2
- 3-5
- 6-8

LOCATION MAP

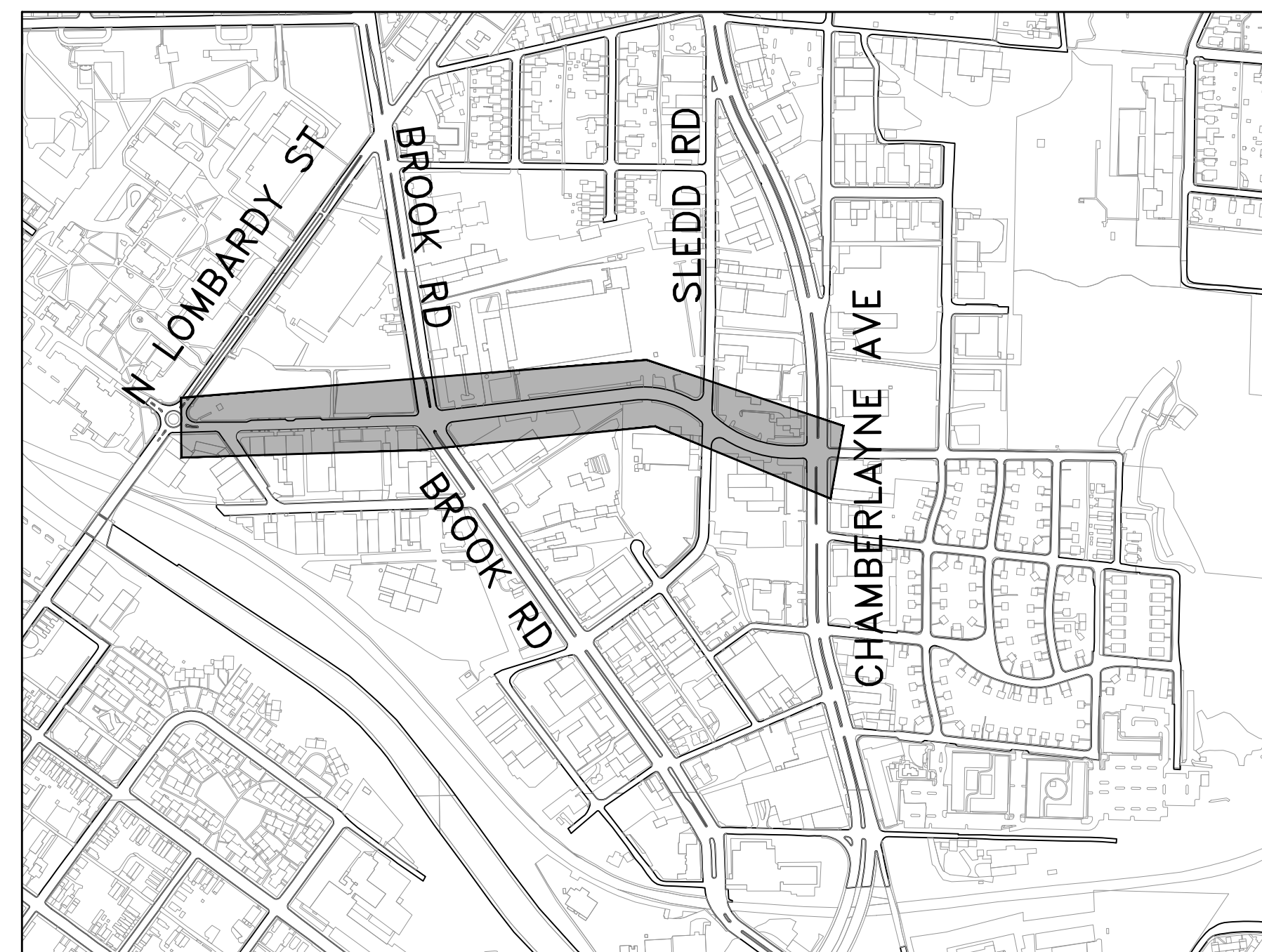

Not To Scale

PROJECT AREA

**60% COMPLETE -
NOT FOR
CONSTRUCTION**

CITY OF RICHMOND
DEPARTMENT OF PUBLIC WORKS
RICHMOND, VIRGINIA

DESIGN FEATURES RELATING TO CONSTRUCTION OR TO REGULATION AND CONTROL OF TRAFFIC MAY BE SUBJECT TO CHANGE AS DEEMED NECESSARY BY THE CITY OF RICHMOND. THIS PROJECT IS TO BE CONSTRUCTED IN ACCORDANCE WITH THE 2020 VDOT ROAD AND BRIDGE SPECIFICATIONS, 2016 VDOT ROAD AND BRIDGE STANDARDS, 2009 FHWA MANUAL ON UNIFORM TRAFFIC CONTROL DEVICES (MUTCD) WITH REVISIONS 1 AND 2 DATED MAY 2012, 2011 VIRGINIA SUPPLEMENT TO THE MUTCD (REVISION 1, DATED SEPTEMBER 30, 2013), 2011 VIRGINIA WORK AREA PROTECTION MANUAL (REVISION 2.1, DATED NOVEMBER 1, 2020), APPLICABLE CITY OF RICHMOND STANDARDS AND SPECIFICATIONS, AND AS AMENDED BY CONTRACT PROVISIONS AND THE COMPLETE ELECTRONIC VERSION OF THE PLAN ASSEMBLY.

NO ADDITIONAL RIGHT OF WAY REQUIRED FOR THIS PROJECT.

AUGUST 2022



P: 804.782.1903
2100 E. Cary St. Suite 309 | Richmond, VA 23223

Engineers | Construction Managers | Planners | Scientists
www.rkk.com

Responsive People | Creative Solutions

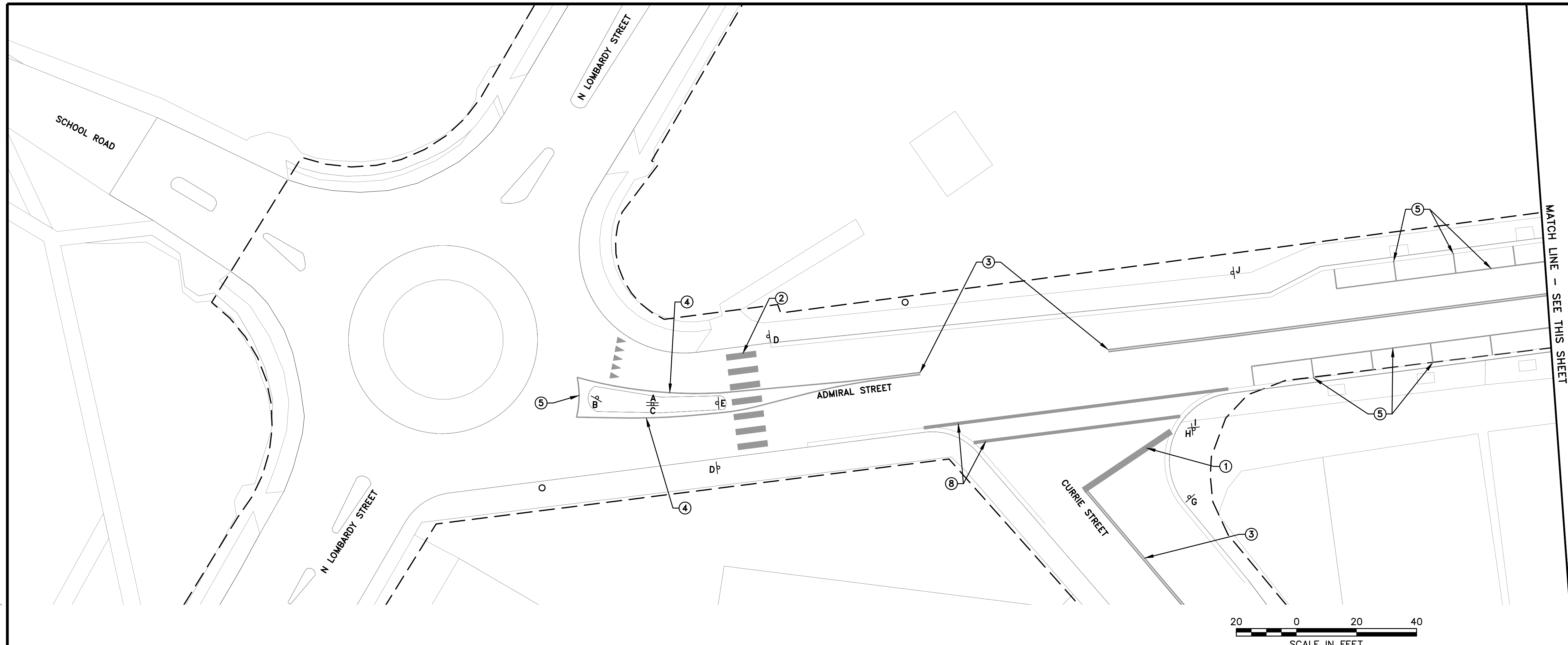

EXISTING SIGN LEGEND

- A: ADOPT-A-STREET SIGN
- B: ADMIRAL ST, RIGHT ARROW STREET NAME SIGN
- C: ONE WAY (R6-2R) SIGN
- D: PEDESTRIAN (W11-2) SIGN
- E: DOWNWARD DIAGONAL ARROW (W16-7PL) SIGN
- F: KEEP RIGHT (R4-7) SIGN
- G: NO PARKING / TOWING, RIGHT ARROW SIGN
- H: STOP (R1-1) SIGN
- I: CURRIE ST 1800 STREET NAME SIGN
- J: ADMIRAL ST 1300 STREET NAME SIGN
- K: ROUNDABOUT (W2-6) SIGN
- L: ADVISORY SPEED 15 (W13-1P) SIGN
- M: 30 MINUTE PARKING, 8AM-6PM, MON.-FRI. SIGN
- N: KEEP RIGHT (R4-7) SIGN
- O: OBJECT MARKER (OM3-L) SIGN
- P: NO PARKING, RIGHT ARROW SIGN
- Q: BIKE LANE SIGN / BLACK AND YELLOW
- R: NO PARKING / TOWING, LEFT-RIGHT ARROW SIGN
- S: NO PARKING (R8-3) SIGN
- T: INTERSECTION WARNING (W2-1) SIGN
- U: SPEED LIMIT 25 (R2-1) SIGN
- V: NO PARKING, LEFT ARROW SIGN
- W: NO PARKING / TOWING, LEFT ARROW SIGN
- X: AHEAD SIGN / BLACK AND YELLOW
- Y: NO PARKING / PASSENGER LOADING ZONE, RIGHT ARROW SIGN
- Z: NO PARKING / TOWING SIGN
- AA: RIGHT LANE MUST TURN RIGHT (R3-7R) SIGN
- AB: SLEDD ST 1800 STREET NAME SIGN
- AC: SLEDD ST 1900 STREET NAME SIGN
- AD: SCHOOL ST 900 STREET NAME SIGN
- AE: CHAMBERLAYNE AV 1700 STREET NAME SIGN
- AF: SCHOOL ST 1000 STREET NAME SIGN

EXISTING PAVEMENT MARKINGS LEGEND

- ①: 24" SOLID WHITE STOP BAR
- ②: 24" SOLID WHITE CROSSWALK LADDER BARS
- ③: 4" SOLID YELLOW LINE (DOUBLE)
- ④: 4" SOLID YELLOW LINE
- ⑤: 4" SOLID WHITE LINE
- ⑥: 4" WHITE SKIP LINE (10' LINE, 30' SKIP)
- ⑦: 4" WHITE SKIP LINE (2' LINE, 4' SKIP)
- ⑧: 12" SOLID WHITE LINE
- ⑨: 24" SOLID GREEN CROSSWALK LADDER BARS WITH 4" WHITE LINE AT ENDS

- ▼▼▼ PAVEMENT SYMBOL MARKING YIELD TRIANGLES (2'X3') SPACED 3' ON CENTERS
- ➔ PAVEMENT SYMBOL MARKING ELONGATED ARROW SINGLE (RIGHT)
- ➔ PAVEMENT SYMBOL MARKING ELONGATED ARROW SINGLE (THRU-LEFT)
- ➔ PAVEMENT SYMBOL MARKING ELONGATED ARROW SINGLE (THRU-LEFT-RIGHT)
- ➔ PAVEMENT SYMBOL MARKING ELONGATED ARROW SINGLE (THRU-RIGHT)
- ➔ PAVEMENT SYMBOL MARKING ELONGATED ARROW SINGLE (THRU)
- ➔ PAVEMENT SYMBOL MARKING ELONGATED ARROW SINGLE (LEFT)
- ➔ PAVEMENT SYMBOL MARKING BICYCLIST ARROW (THRU) AND HELMETED BICYCLIST
- ➔ PAVEMENT SYMBOL MARKING SHARROW

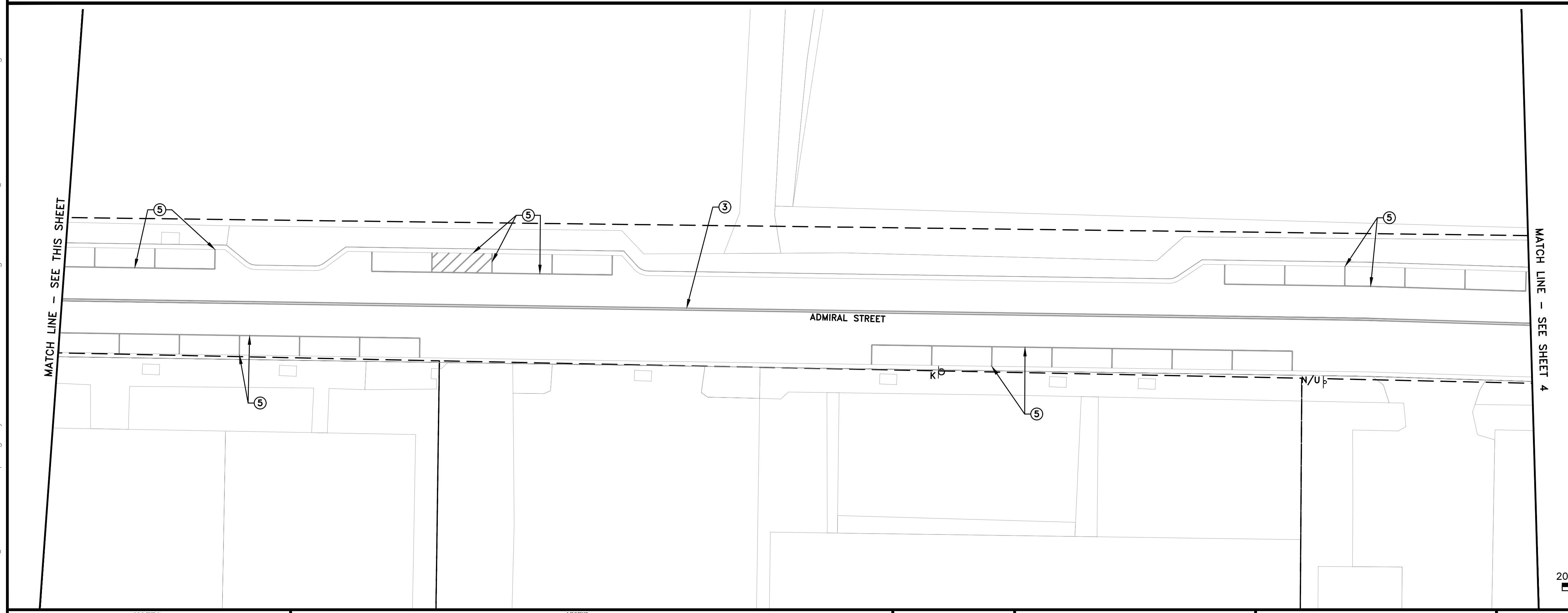

60% COMPLETE:
NOT FOR
CONSTRUCTION

NOTES

1. Lot dimensions in parentheses are from deed.
2. Property owners correct as of 20__.
3. Ordinance Number _____
4. Adopted _____
5. Accepted _____

REFERENCES

Existing	Proposed
Curb & Gutter	Proposed Conc. Sidewalk
Sidewalk	Brick Sidewalk
Basin	Castings: Water Valve
Storm Sewer	Water Meter
Sewer Manhole	Gas Drip
Sanitary Sewer (round)	Gas Valve
Sanitary Sewer (rect. man)	Telephone Manhole
Gas Line	Electric Manhole
Electric Line	Proposed Curb Cut Ramp
Telephone/Telegraph	Decorative Light
TV Cable	Conduit (Conc. Encased)
Water Line	Retaining Wall
Tree / Exst. Tree To Be Removed / Stamp	
Property Line	

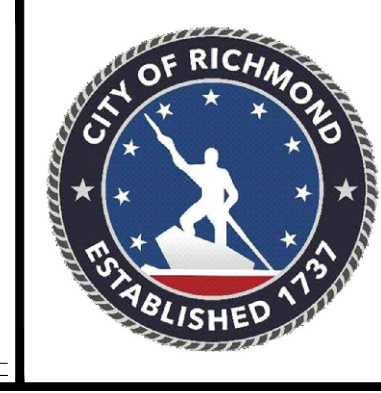

Technical	Administrative
Surveys Superintendent	Capital Project Administrator
Project Manager	City Engineer
Maintenance Engineer	Director of Public Works
City Transportation Engineer	

DEPARTMENT OF PUBLIC WORKS
RICHMOND, VIRGINIA

ADMIRAL STREET/SCHOOL STREET LOMBARDY STREET TO CHAMBERLAYNE AVENUE EXISTING CONDITIONS

VDOT PROJECT NO.: N/A

DESIGN BY: KJF	REVIEWED BY:	FIELD NOTES:	SCALE: 1"=20'	DATE: AUG. 2022	PROJECT: SHEET 3	DRAWING NO.:
CHECKED BY: MMM						

\oadr\hck.com\Fis\Ciouda\Projects\2017\17141_Rich\ADP\Construction Drawings\ADMIRAL ST 13-5 EXISTING CONDITIONS PLAN.dwg, 8/4/2022 9:32:58 AM by ----

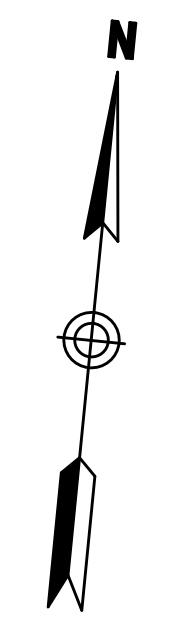
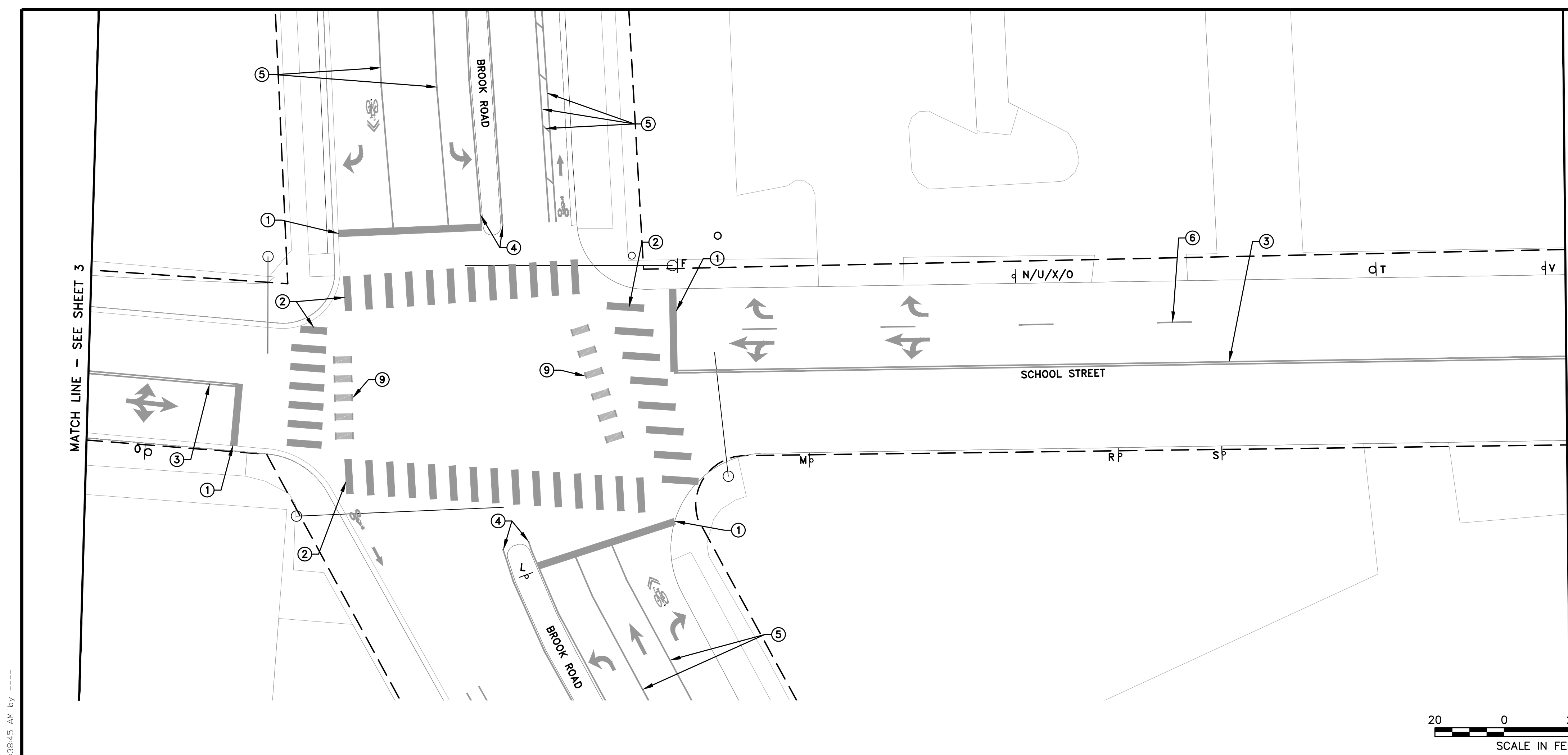

EXISTING SIGN LEGEND	
A:	ADOPT-A-STREET SIGN
B:	ADMIRAL ST, RIGHT ARROW STREET NAME SIGN
C:	ONE WAY (R6-2R) SIGN
D:	PEDESTRIAN (W11-2) SIGN
E:	DOWNWARD DIAGONAL ARROW (W16-7PL) SIGN
F:	KEEP RIGHT (R4-7) SIGN
G:	NO PARKING / TOWING, RIGHT ARROW SIGN
H:	STOP (R1-1) SIGN
I:	CURRIE ST 1800 STREET NAME SIGN
J:	ADMIRAL ST 1300 STREET NAME SIGN
K:	ROUNDABOUT (W2-6) SIGN
L:	ADVISORY SPEED 15 (W13-1P) SIGN
M:	30 MINUTE PARKING, 8AM-6PM, MON.-FRI. SIGN
N:	KEEP RIGHT (R4-7) SIGN
O:	OBJECT MARKER (OM3-L) SIGN
P:	NO PARKING, RIGHT ARROW SIGN
Q:	BIKE LANE SIGN / BLACK AND YELLOW
R:	NO PARKING / TOWING, LEFT-RIGHT ARROW SIGN
S:	NO PARKING (R8-3) SIGN
T:	INTERSECTION WARNING (W2-1) SIGN
U:	SPEED LIMIT 25 (R2-1) SIGN
V:	NO PARKING, LEFT ARROW SIGN
W:	NO PARKING / TOWING, LEFT ARROW SIGN
X:	AHEAD SIGN / BLACK AND YELLOW
Y:	NO PARKING / PASSENGER LOADING ZONE, RIGHT ARROW SIGN
Z:	NO PARKING / TOWING SIGN
AA:	RIGHT LANE MUST TURN RIGHT (R3-7R) SIGN
AB:	SLEDD ST 1800 STREET NAME SIGN
AC:	SLEDD ST 1900 STREET NAME SIGN
AD:	SCHOOL ST 900 STREET NAME SIGN
AE:	CHAMBERLAYNE AV 1700 STREET NAME SIGN
AF:	SCHOOL ST 1000 STREET NAME SIGN

EXISTING PAVEMENT MARKINGS LEGEND	
①:	24" SOLID WHITE STOP BAR
②:	24" SOLID WHITE CROSSWALK LADDER BARS
③:	4" SOLID YELLOW LINE (DOUBLE)
④:	4" SOLID YELLOW LINE
⑤:	4" SOLID WHITE LINE
⑥:	4" WHITE SKIP LINE (10' LINE, 30' SKIP)
⑦:	4" WHITE SKIP LINE (2' LINE, 4' SKIP)
⑧:	12" SOLID WHITE LINE
⑨:	24" SOLID GREEN CROSSWALK LADDER BARS WITH 4" WHITE LINE AT ENDS
▼▼▼	PAVEMENT SYMBOL MARKING YIELD TRIANGLES (2'X3') SPACED 3' ON CENTERS
↷	PAVEMENT SYMBOL MARKING ELONGATED ARROW SINGLE (RIGHT)
↶	PAVEMENT SYMBOL MARKING ELONGATED ARROW SINGLE (THRU-LEFT)
↷↶	PAVEMENT SYMBOL MARKING ELONGATED ARROW SINGLE (THRU-LEFT-RIGHT)
↶↷	PAVEMENT SYMBOL MARKING ELONGATED ARROW SINGLE (THRU-RIGHT)
↷	PAVEMENT SYMBOL MARKING ELONGATED ARROW SINGLE (THRU)
↶	PAVEMENT SYMBOL MARKING ELONGATED ARROW SINGLE (LEFT)
↷↶↷	PAVEMENT SYMBOL MARKING ELONGATED ARROW SINGLE (THRU) AND HELMETED BICYCLIST
↷↶↷↶	PAVEMENT SYMBOL MARKING SHARROW

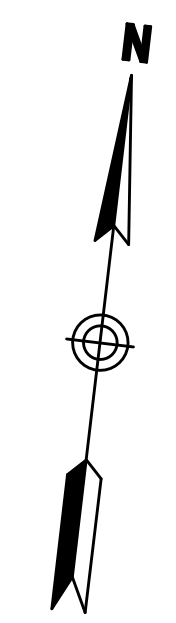
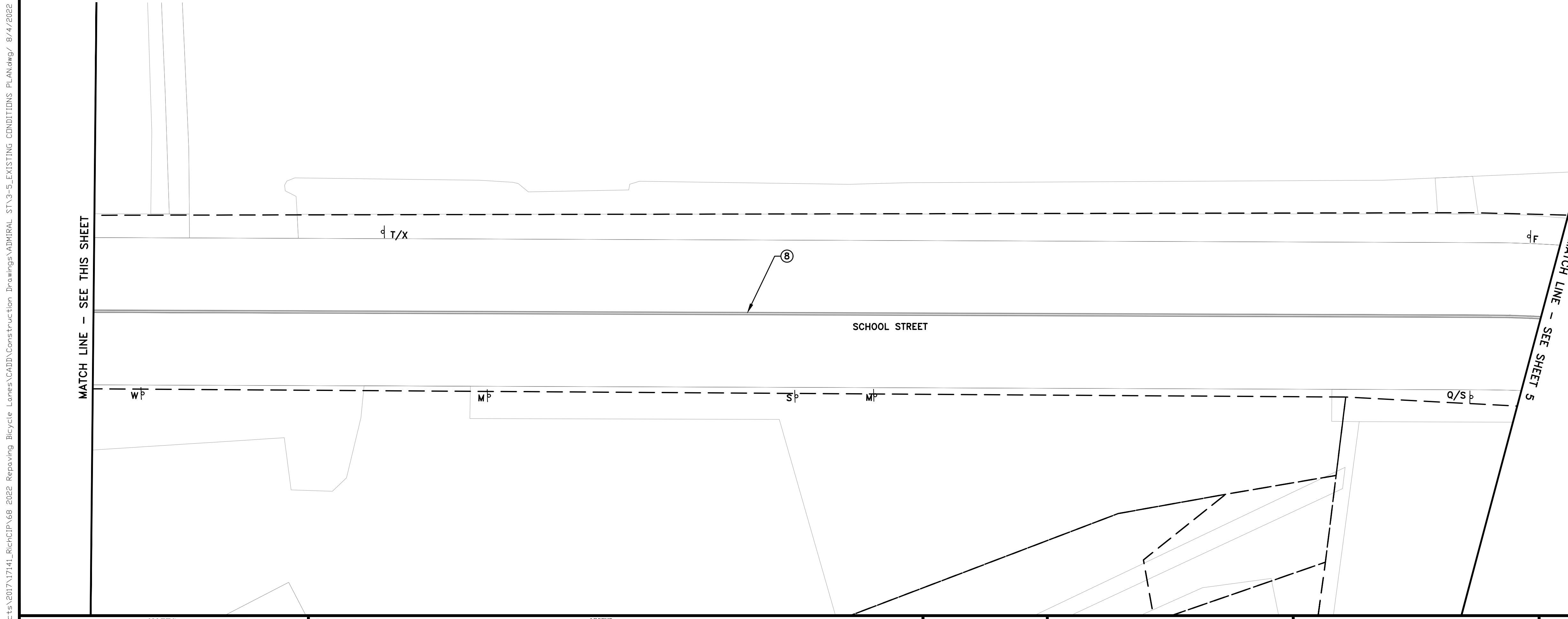

60% COMPLETE:
NOT FOR
CONSTRUCTION

NOTES
1. Lot dimensions in parentheses are from deed.
2. Property owners correct as of 20__
3. Ordinance Number _____
4. Adopted _____
5. Accepted _____

Existing	Proposed
Curb & Gutter	Conc. Sidewalk
Sidewalk	Brick Sidewalk
Basin	Castings: Water Valve
Storm Sewer	Water Meter
Sewer Manhole	Gas Drip
Sanitary Sewer (round)	Gas Valve
Sanitary Sewer (rect. man)	Telephone Manhole
Gas Line	Electric Manhole
Electric Line	Proposed Curb Cut Ramp
Telephone/Telegraph	Decorative Light
TV Cable	Conduit (Conc. Encased)
Water Line	Retaining Wall
Tree / Exst. Tree To Be Removed / Stamp	
Property Line	



Technical	Administrative
Surveys Superintendent	
Project Manager	Capital Project Administrator
Maintenance Engineer	City Engineer
City Transportation Engineer	Director of Public Works

DEPARTMENT OF PUBLIC WORKS
RICHMOND, VIRGINIA

Responsive People • Creative Solutions

ADMIRAL STREET/SCHOOL STREET

LOMBARDY STREET TO CHAMBERLAYNE AVENUE

EXISTING CONDITIONS

VDOT PROJECT NO.: N/A

AUTHORITY: CITY OF RICHMOND

DESIGN BY: KJF
DRAWN BY: MMM
CHECKED BY: MMM

REVIEWED BY: _____

FIELD NOTES: _____

SCALE: 1"=20'

DATE: AUG. 2022

PROJECT SHEET: 4

DRAWING NO.: _____

\\oadr-hk.com\Fis\Cad\Projects\2017\17141_Rich\AD\Construction Drawings\ADMIRAL ST 3-3-5_EXISTING CONDITIONS PLAN.dwg, 8/4/2022 9:38:45 AM by ----

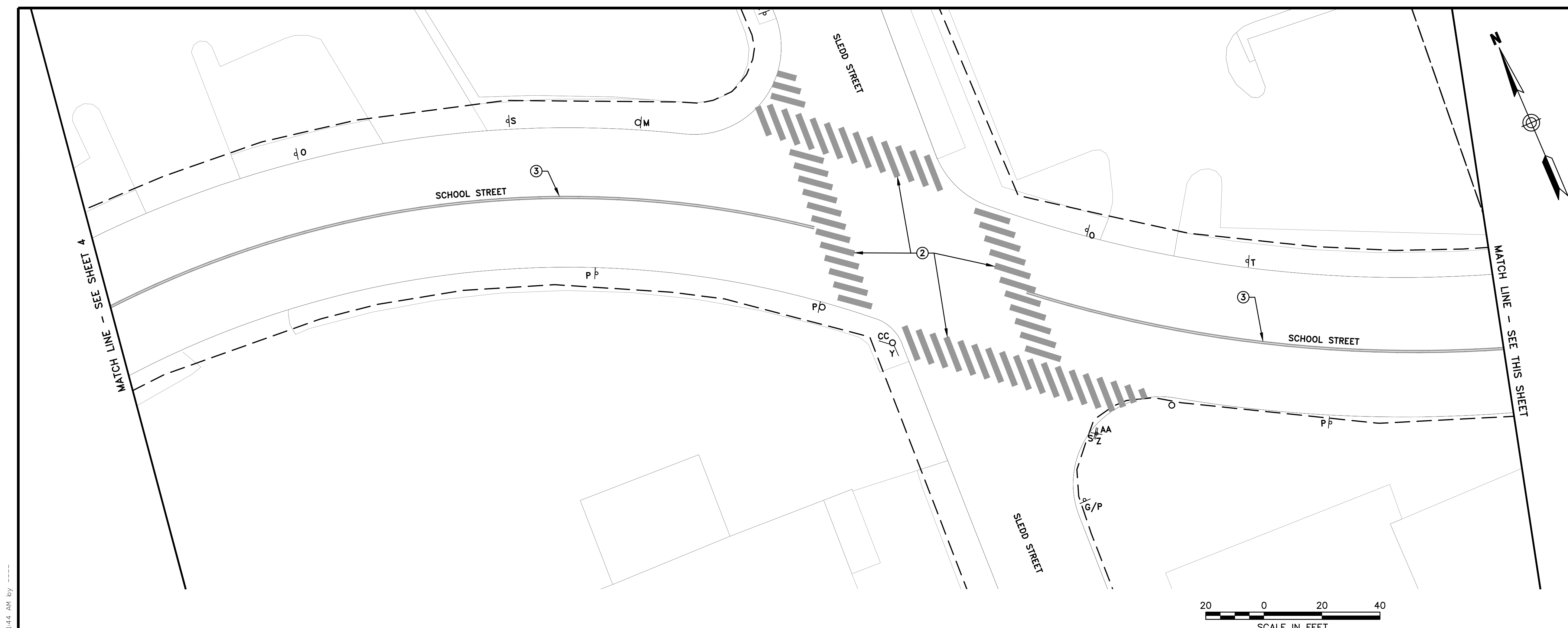

EXISTING SIGN LEGEND	
A:	ADOPT-A-STREET SIGN
B:	ADMIRAL ST, RIGHT ARROW STREET NAME SIGN
C:	ONE WAY (R6-2R) SIGN
D:	PEDESTRIAN (W11-2) SIGN
E:	DOWNWARD DIAGONAL ARROW (W16-7PL) SIGN
F:	KEEP RIGHT (R4-7) SIGN
G:	NO PARKING / TOWING, RIGHT ARROW SIGN
H:	STOP (R1-1) SIGN
I:	CURRIE ST 1800 STREET NAME SIGN
J:	ADMIRAL ST 1300 STREET NAME SIGN
K:	ROUNDABOUT (W2-6) SIGN
L:	ADVISORY SPEED 15 (W13-1P) SIGN
M:	30 MINUTE PARKING, 8AM-6PM, MON.-FRI. SIGN
N:	KEEP RIGHT (R4-7) SIGN
O:	OBJECT MARKER (OM3-L) SIGN
P:	NO PARKING, RIGHT ARROW SIGN
Q:	BIKE LANE SIGN / BLACK AND YELLOW
R:	NO PARKING / TOWING, LEFT-RIGHT ARROW SIGN
S:	NO PARKING (R8-3) SIGN
T:	INTERSECTION WARNING (W2-1) SIGN
U:	R SPEED LIMIT 25 (R2-1) SIGN
V:	NO PARKING, LEFT ARROW SIGN
W:	NO PARKING / TOWING, LEFT ARROW SIGN
X:	AHEAD SIGN / BLACK AND YELLOW
Y:	NO PARKING / PASSENGER LOADING ZONE, RIGHT ARROW SIGN
Z:	NO PARKING / TOWING SIGN
AA:	RIGHT LANE MUST TURN RIGHT (R3-7R) SIGN
BB:	SLEDD ST 1800 STREET NAME SIGN
CC:	SLEDD ST 900 STREET NAME SIGN
CC:	SCHOOL ST 1000 STREET NAME SIGN

EXISTING PAVEMENT MARKINGS LEGEND	
①:	24" SOLID WHITE STOP BAR
②:	24" SOLID WHITE CROSSWALK LADDER BARS
③:	4" SOLID YELLOW LINE (DOUBLE)
④:	4" SOLID YELLOW LINE
⑤:	4" SOLID WHITE LINE
⑥:	4" WHITE SKIP LINE (10' LINE, 30' SKIP)
⑦:	4" WHITE SKIP LINE (2' LINE, 4' SKIP)
⑧:	4" SOLID WHITE LINE
⑨:	24" SOLID GREEN CROSSWALK LADDER BARS WITH 4" WHITE LINE AT ENDS
▼▼▼	PAVEMENT SYMBOL MARKING YIELD TRIANGLES (2'X3') SPACED 3' ON CENTERS
↷	PAVEMENT SYMBOL MARKING ELONGATED ARROW SINGLE (RIGHT)
↶	PAVEMENT SYMBOL MARKING ELONGATED ARROW SINGLE (THRU-LEFT)
↷↶	PAVEMENT SYMBOL MARKING ELONGATED ARROW SINGLE (THRU-LEFT-RIGHT)
↶↷	PAVEMENT SYMBOL MARKING ELONGATED ARROW SINGLE (THRU-RIGHT)
↷	PAVEMENT SYMBOL MARKING ELONGATED ARROW SINGLE (THRU)
↶	PAVEMENT SYMBOL MARKING ELONGATED ARROW SINGLE (LEFT)
↷↶	PAVEMENT SYMBOL MARKING BICYCLIST ARROW (THRU) AND HELMETED BICYCLIST
↷↶	PAVEMENT SYMBOL MARKING SHARROW

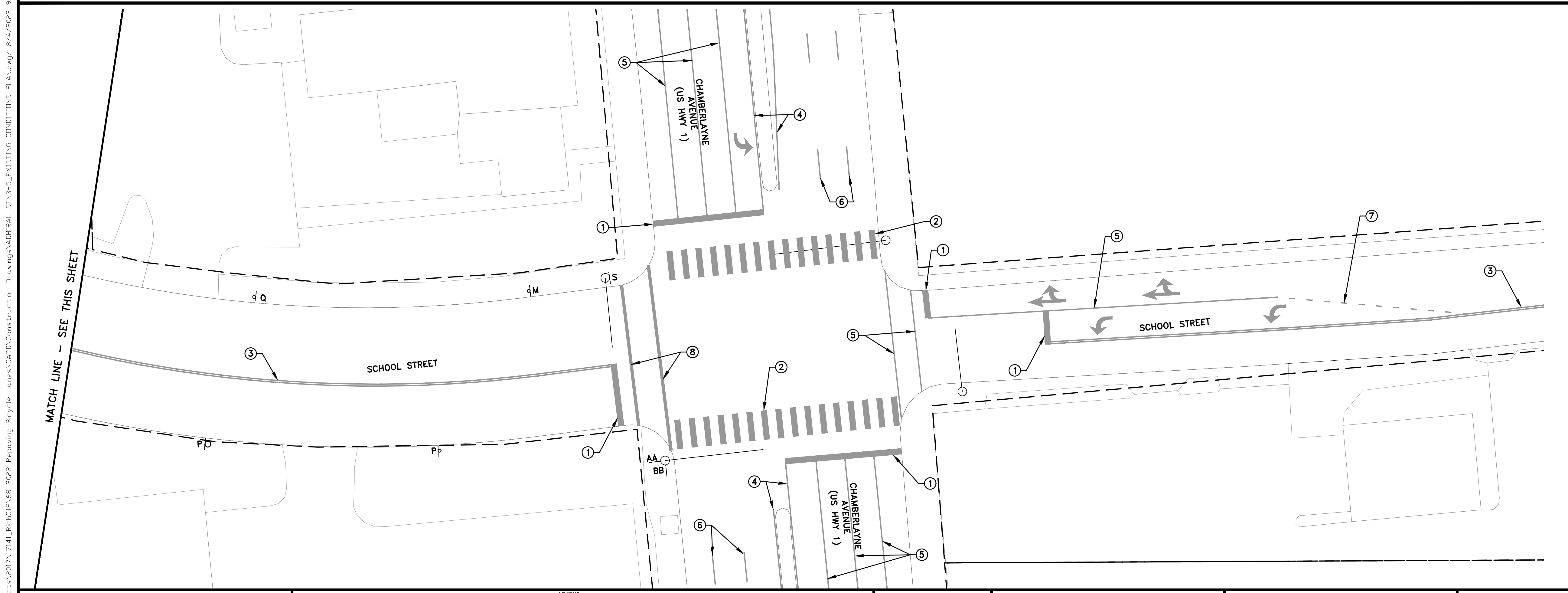
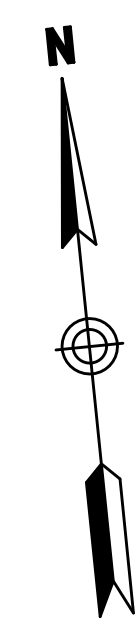

60% COMPLETE:
NOT FOR
CONSTRUCTION

NOTES	
1.	Lot dimensions in parentheses are from deed.
2.	Property owners correct as of _____ 20__
3.	Ordinance Number _____
4.	Adopted _____
5.	Accepted _____

Existing	Proposed
Curb & Gutter	Conc. Sidewalk
Sidewalk	Brick Sidewalk
Basin	Castings: Water Valve
Storm Sewer	Water Meter
Sewer Manhole	Gas Drip
Sanitary Sewer (new)	Gas Valve
Sanitary Sewer (re-use)	Telephone Manhole
Gas Line	Electric Manhole
Electric Line	Property Pin
Telephone/Telegraph	Utility Pole
TV Cable	Proposed Curb Cut Ramp
Water Line	Decorative Light
Tree / Exst. Tree To Be Removed / Stamp	Conduit (Conc. Encased)
Property Line	Retaining Wall



Technical	Administrative
Surveys Superintendent	
Project Manager	Capital Project Administrator
Maintenance Engineer	City Engineer
City Transportation Engineer	Director of Public Works

DEPARTMENT OF PUBLIC WORKS
RICHMOND, VIRGINIA

ADMIRAL STREET/SCHOOL STREET
LOMBARDY STREET TO CHAMBERLAYNE AVENUE
EXISTING CONDITIONS

VDOT PROJECT NO.: N/A

DESIGN BY: KJF	REVIEWED BY:	FIELD NOTES:	SCALE: 1"=20'	DATE: AUG. 2022	PROJECT: SHEET 5	DRAWING NO.:
CHECKED BY: MMM						

\\oad-rk.com\Fis\Ciudad\Projects\2017\17141_Rich\Construction Drawings\ADMIRAL ST-3-5_EXISTING CONDITIONS PLAN.dwg, 8/4/2022 9:31:44 AM by ----

\\adarkh.com\Projects\2017\17141_RichCIP\68_2022_Repaving_Bicycle_Lanes\CADD\Construction_Drawings\ADMIRAL_ST\6-8_PROPOSED CONDITIONS PLAN - CONDITIONS.dwg / 8/4/2022 1:58:30 PM

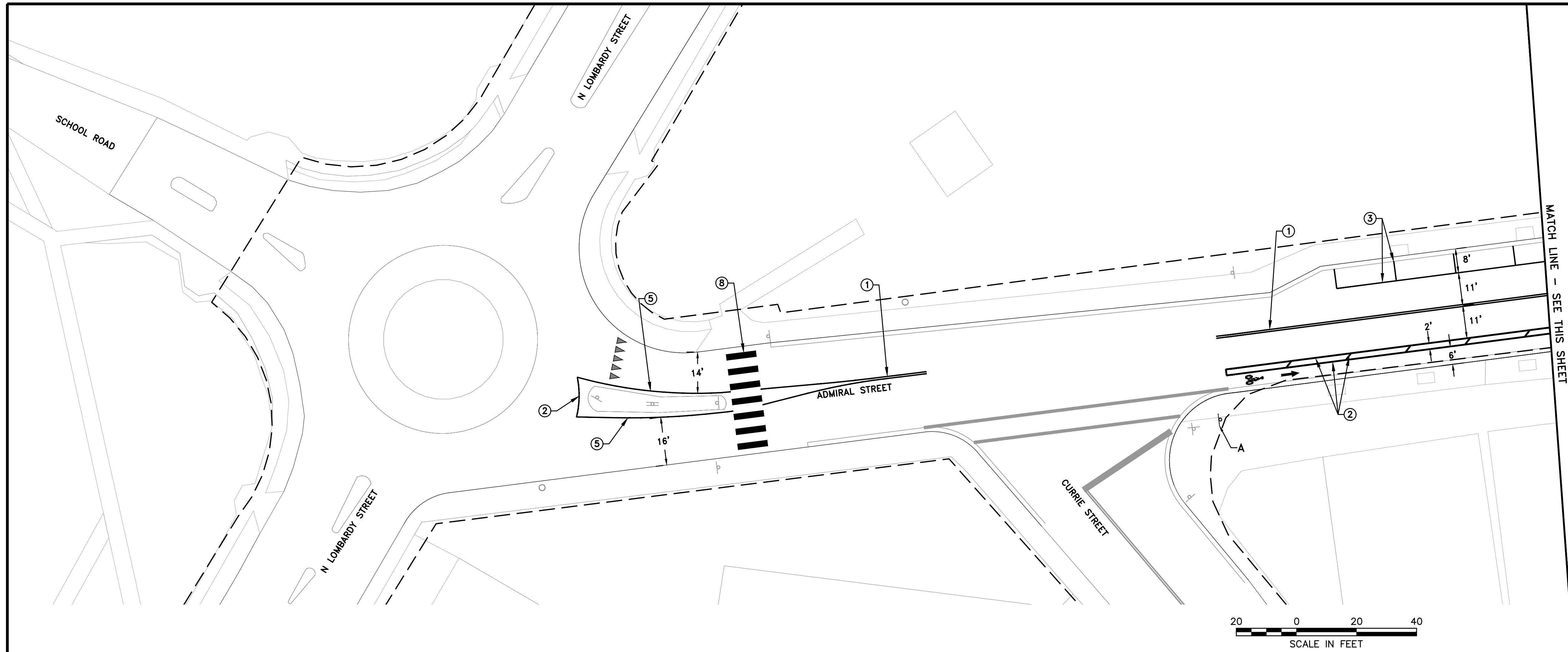

MATCH LINE - SEE THIS SHEET

PROPOSED PAVEMENT MARKING LEGEND

- ①: 4" SOLID YELLOW LINE (DOUBLE) WITH 4" SPACE
 - ②: 6" SOLID WHITE LINE
 - ③: 4" SOLID WHITE LINE
 - ④: 24" SOLID WHITE STOP BAR
 - ⑤: 4" SOLID YELLOW LINE (SINGLE)
 - ⑥: 4" WHITE SKIP LINE (10' LINE, 30' SKIP)
 - ⑦: 6" WHITE SKIP LINE (2' LINE, 6' SKIP)
 - ⑧: 24" SOLID WHITE CROSSWALK LADDER BARS
 - ⑨: 24" SOLID GREEN CROSSWALK LADDER BARS WITH 4" WHITE LINE AT ENDS
- ← PAVEMENT SYMBOL MARKING BICYCLIST ARROW (THRU) AND HELMETED BICYCLIST
 - ↔ PAVEMENT SYMBOL MARKING SHARROW
 - ↩ PAVEMENT SYMBOL MARKING ELONGATED ARROW SINGLE (LEFT)
 - ↪ PAVEMENT SYMBOL MARKING ELONGATED ARROW SINGLE (RIGHT)
 - ↔ PAVEMENT SYMBOL MARKING ELONGATED ARROW SINGLE (THRU-LEFT)
 - ▼▼▼ PAVEMENT SYMBOL MARKING YIELD TRIANGLES (2'X3') SPACED 3' ON CENTERS
 - ENDS PAVEMENT MESSAGE MARKING BIKE LANE ENDS

PROPOSED SIGN LEGEND

- A: BIKE LANE SIGN (R3-17, 24"X18")
- B: BIKE LANE SIGN (R3-17, 24"X18") ENDS SIGN (R3-17BP, 24"X8")
- C: BEGIN RIGHT TURN LANE YIELD TO BIKES (R4-4, 36"X30")

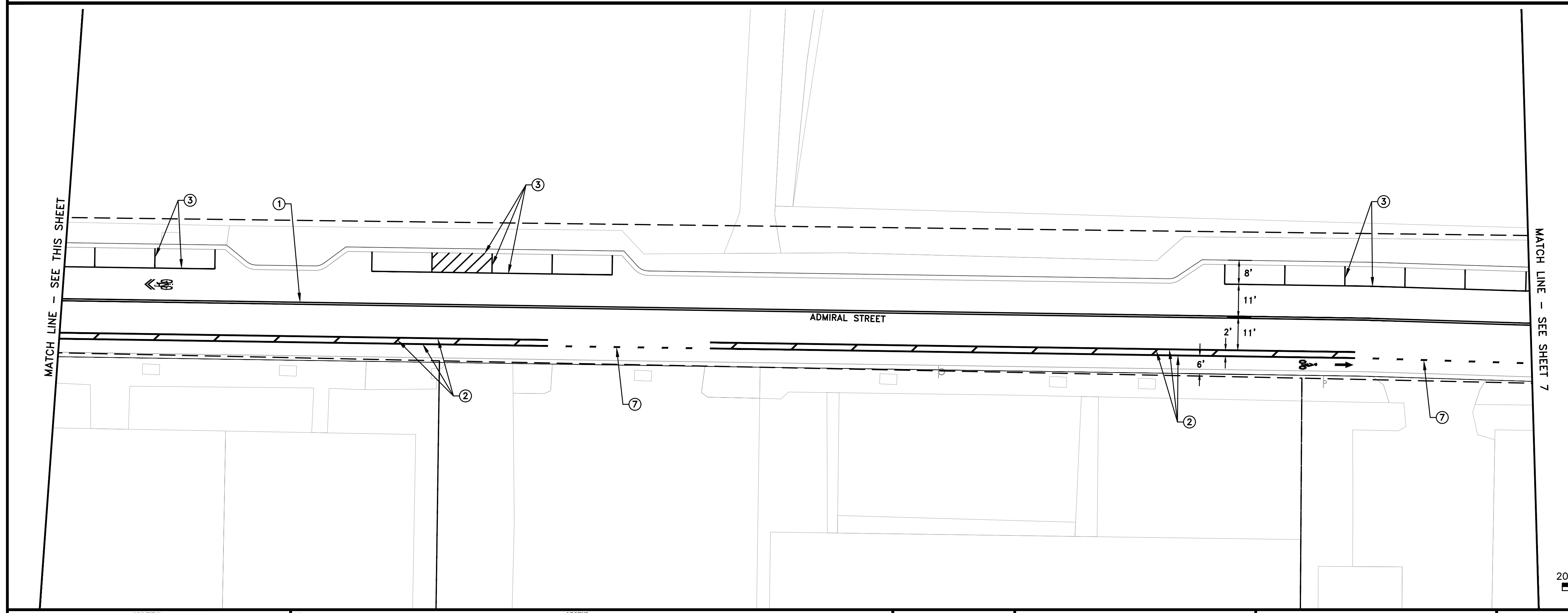

MATCH LINE - SEE SHEET 7

60% COMPLETE:
NOT FOR
CONSTRUCTION

NOTES

1. Lot dimensions in parentheses are from deed.
2. Property owners correct as of 20__
3. Ordinance Number _____
4. Adopted _____
5. Accepted _____

REFERENCES **REVISIONS**

Existing	Proposed	Legend
Curb & Gutter	Proposed Conc. Sidewalk	Brick Sidewalk
Sidewalk	Castings: Water Valve	Water Meter
Basin	Water Meter	Gas Drip
Storm Sewer	Gas Valve	Gas Valve
Sewer Manhole	Telephone Manhole	Electric Manhole
Sanitary Sewer (new)	Electric Manhole	Proposed Curb Cut Ramp
Sanitary Sewer (new Man)	Proposed Curb Cut Ramp	Decorative Light
Gas Line	Decorative Light	Conduit (Conc. Encased)
Electric Line	Conduit (Conc. Encased)	Retaining Wall
Telephone/Telegraph	Retaining Wall	
TV Cable		
Water Line		
Tree / Exst. Tree To Be Removed / Stamp		
Property Line		



Technical	Administrative
Surveys Superintendent	Capital Project Administrator
Project Manager	City Engineer
Maintenance Engineer	Director of Public Works
City Transportation Engineer	

DEPARTMENT OF PUBLIC WORKS
RICHMOND, VIRGINIA

Responsive People • Creative Solutions

**ADMIRAL STREET/SCHOOL STREET
LOMBARDY STREET TO CHAMBERLAYNE AVENUE
PROPOSED CONDITIONS**

VDOT PROJECT NO.: N/A

DESIGN BY: KJF	REVIEWED BY:	FIELD NOTES:	SCALE: 1"=20'	DATE: AUG. 2022	PROJECT: SHEET 6	DRAWING NO.:
CHECKED BY: MMM						

\\adp\hickman\p\Cloud\Projects\2017\17141_RichCIP\68_2022_Repaving_Bicycle_Lanes\CADD\Construction_Drawings\ADMIRAL_ST\6-8_PROPOSED CONDITIONS PLAN - CONDITIONS.dwg / 8/4/2022 1:58:42 PM By: ---

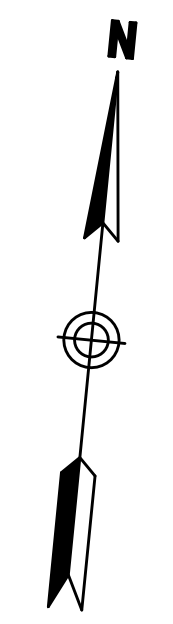
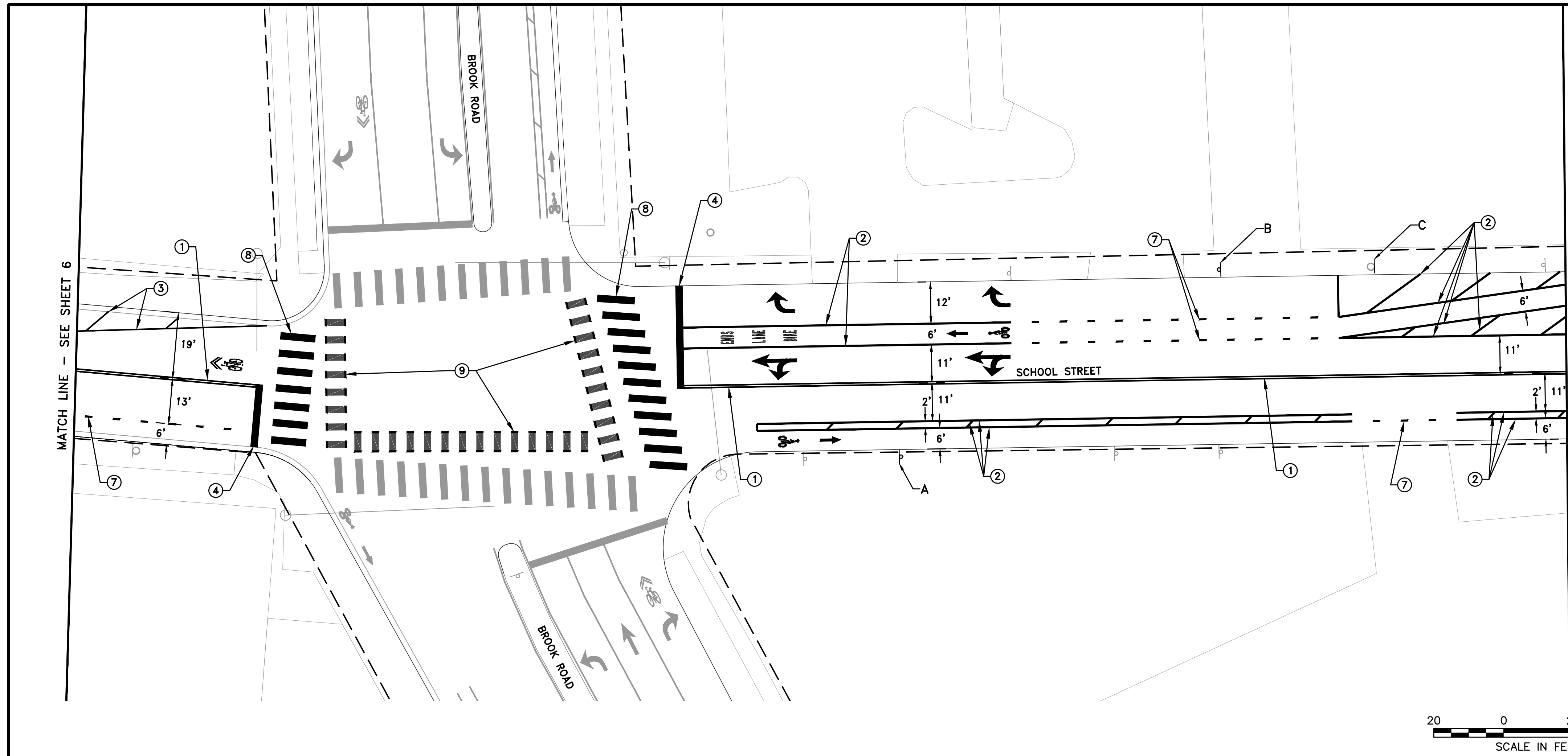

PROPOSED PAVEMENT MARKING LEGEND

- ① : 4" SOLID YELLOW LINE (DOUBLE) WITH 4" SPACE
 - ② : 6" SOLID WHITE LINE
 - ③ : 4" SOLID WHITE LINE
 - ④ : 24" SOLID WHITE STOP BAR
 - ⑤ : 4" SOLID YELLOW LINE (SINGLE)
 - ⑥ : 4" WHITE SKIP LINE (10' LINE, 30' SKIP)
 - ⑦ : 6" WHITE SKIP LINE (2' LINE, 6' SKIP)
 - ⑧ : 24" SOLID WHITE CROSSWALK LADDER BARS
 - ⑨ : 24" SOLID GREEN CROSSWALK LADDER BARS WITH 4" WHITE LINE AT ENDS
- PAVEMENT SYMBOL MARKING BICYCLIST ARROW (THRU) AND HELMETED BICYCLIST
 - PAVEMENT SYMBOL MARKING SHARROW
 - PAVEMENT SYMBOL MARKING ELONGATED ARROW SINGLE (LEFT)
 - PAVEMENT SYMBOL MARKING ELONGATED ARROW SINGLE (RIGHT)
 - PAVEMENT SYMBOL MARKING ELONGATED ARROW SINGLE (THRU-LEFT)
 - PAVEMENT SYMBOL MARKING YIELD TRIANGLES (2'X3') SPACED 3' ON CENTERS
 - PAVEMENT MESSAGE MARKING BIKE LANE ENDS

PROPOSED SIGN LEGEND

- A: BIKE LANE SIGN (R3-17, 24"X18")
- B: BIKE LANE SIGN (R3-17, 24"X18") ENDS SIGN (R3-17BP, 24"X8")
- C: BEGIN RIGHT TURN LANE YIELD TO BIKES (R4-4, 36"X30")

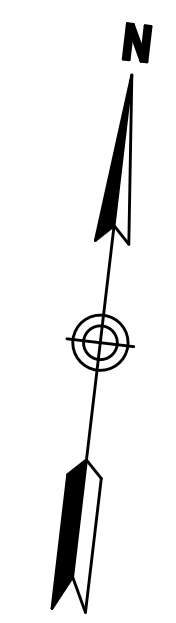
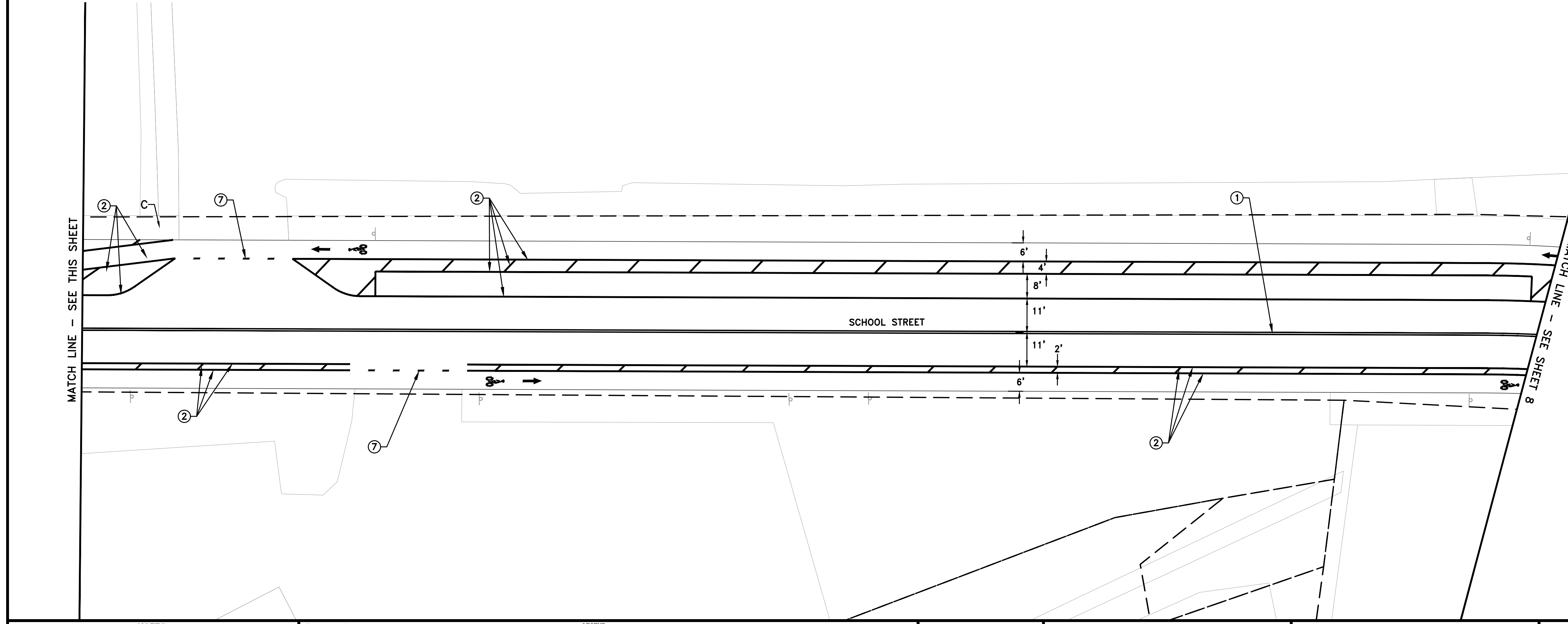

60% COMPLETE:
NOT FOR
CONSTRUCTION

NOTES

1. Lot dimensions in parentheses are from deed.
2. Property owners correct as of 20__
3. Ordinance Number _____
4. Adopted _____
5. Accepted _____

REFERENCES

Existing		Proposed	
Curb & Gutter		Proposed Conc. Sidewalk	
Sidewalk		Brick Sidewalk	
Basin		Castings: Water Valve	
Storm Sewer		Water Meter	
Sewer Manhole		Gas Drip	
Sanitary Sewer (open)		Gas Valve	
Sanitary Sewer (have Man)		Telephone Manhole	
Gas Line		Electric Manhole	
Electric Line		Proposed Curb Cut Ramp	
Telephone/Telegraph		Decorative Light	
TV Cable		Conduit	
Water Line		Conduit (Conc. Encased)	
Tree / Exst. Tree To Be Removed / Stamp		Retaining Wall	
Property Line			



Technical	Administrative
Surveys Superintendent	
Project Manager	Capital Project Administrator
Maintenance Engineer	City Engineer
City Transportation Engineer	Director of Public Works

DEPARTMENT OF PUBLIC WORKS
RICHMOND, VIRGINIA

Responsive People • Creative Solutions

ADMIRAL STREET/SCHOOL STREET
LOMBARDY STREET TO CHAMBERLAYNE AVENUE
PROPOSED CONDITIONS

VDOT PROJECT NO.: N/A

DESIGN BY: KJF	REVIEWED BY:	FIELD NOTES:	SCALE: 1"=20'	DATE: AUG. 2022	PROJECT: SHEET 7	DRAWING NO.:
CHECKED BY: MMM						

