

## Richmond Slave Trail Project Narrative

Three key components comprise the Improvements to the City of Richmond Slave Trail between Ancarrow's Landing and the Floodwall Enclosure at Brander Street west of the I-95/James River Bridge.

The first component, a new trailhead/orientation amphitheater in the grassy field between the James River and the Ancarrow's parking area, clearly marks the beginning of the Richmond Slave Trail while orienting users to the historical and cultural significance of the trail. It serves as a gathering point and small amphitheater for guided tours, an experiential exhibit, and wayfinding for self-guided users. The interactive trailhead is sited in the Ancarrow's Landing field adjacent to the river and pointing upstream, as a transatlantic slave trading ship would effectively dock along the banks of the James River to counteract current.

The second component maintains the route of the Richmond Slave Trail but provides necessary improvements along the trail between Ancarrow's Landing and the I-95/James River Bridge. New wooden fencing will be added in locations requested by the owner, and one of the dated pedestrian bridges will be replaced to increase structural integrity. Natural wood mulch will continue as the trail's surface material to maintain the historic experience of walking the trail.

The third component provides directional clarity for multiple users at the area underneath the I-95 bridge overpass at the Brander Street floodwall closure. A 6'-0" wide, clearly marked bike and pedestrian lane buffered by a 2'-0" wide painted striped buffer separates trail users from vehicular traffic on Brander Street. The trail subdivides after the furthest west bridge column to bring pedestrian users onto the existing trail as it enters the wooded area east of the bridge, while pavement markings direct cyclists to the existing bike trail paralleling Brander Street.

Funding for the project comes out of the \$1M allocated from the Virginia General Assembly Funds for overall improvements to the Richmond Slave Trail. Construction would begin once the project is awarded. Traffic implications would be minimized as the majority of construction is located off the street grid, adjacent to the Ancarrow's Landing parking area.

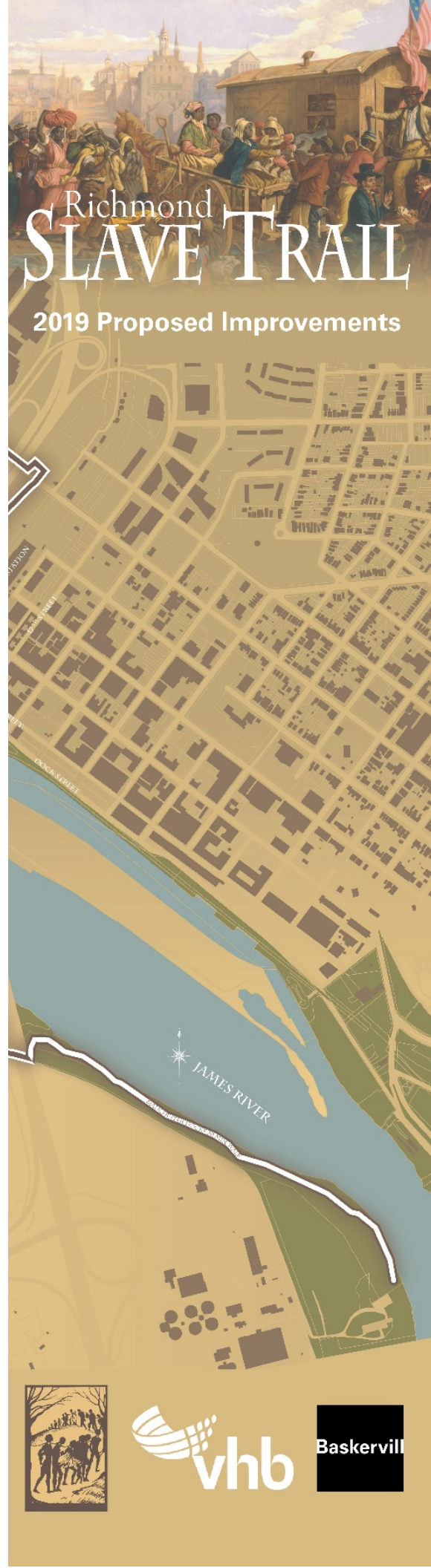

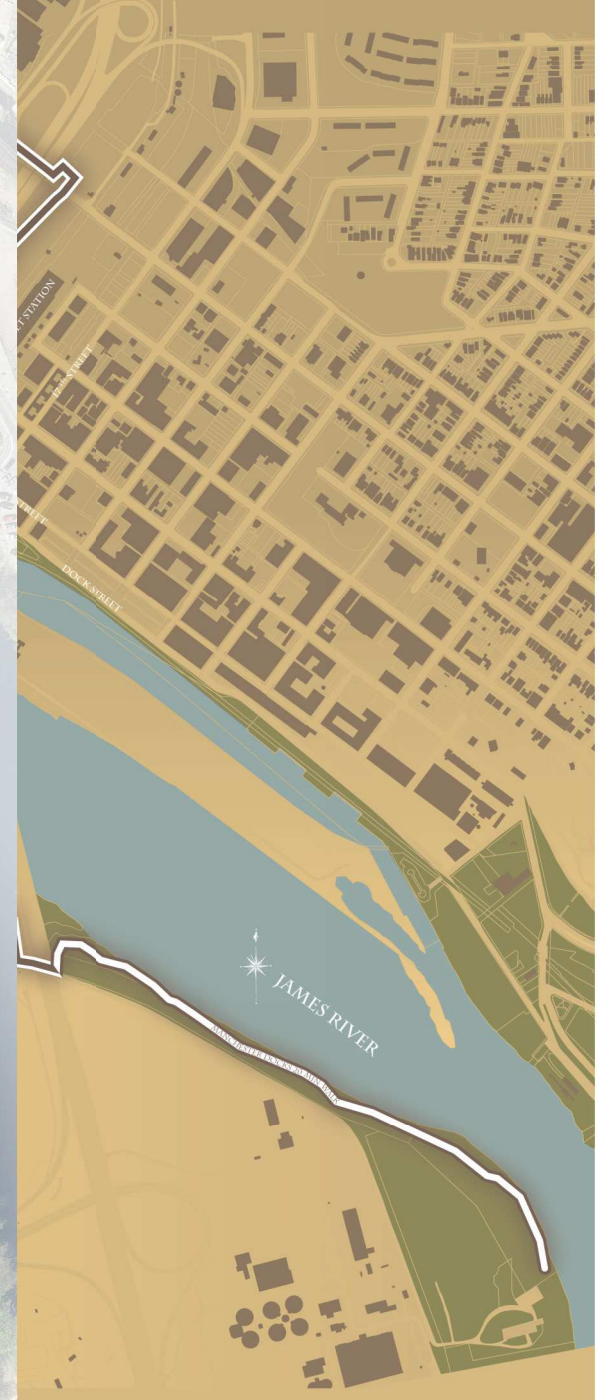

**Richmond Slave Trail  
Presentation**  
January 16, 2019



# Richmond SLAVE TRAIL

2019 Proposed Improvements

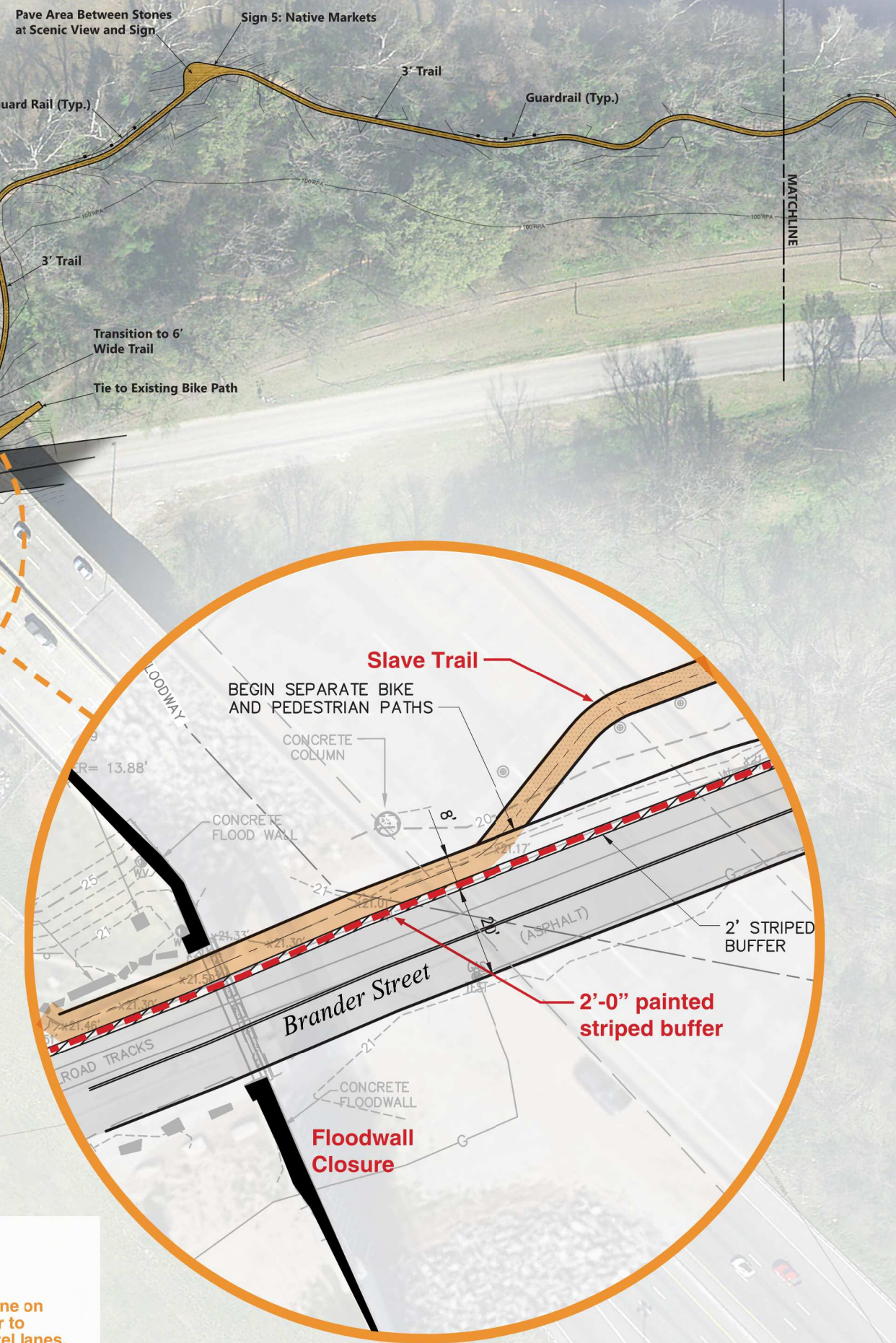
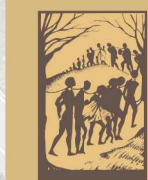
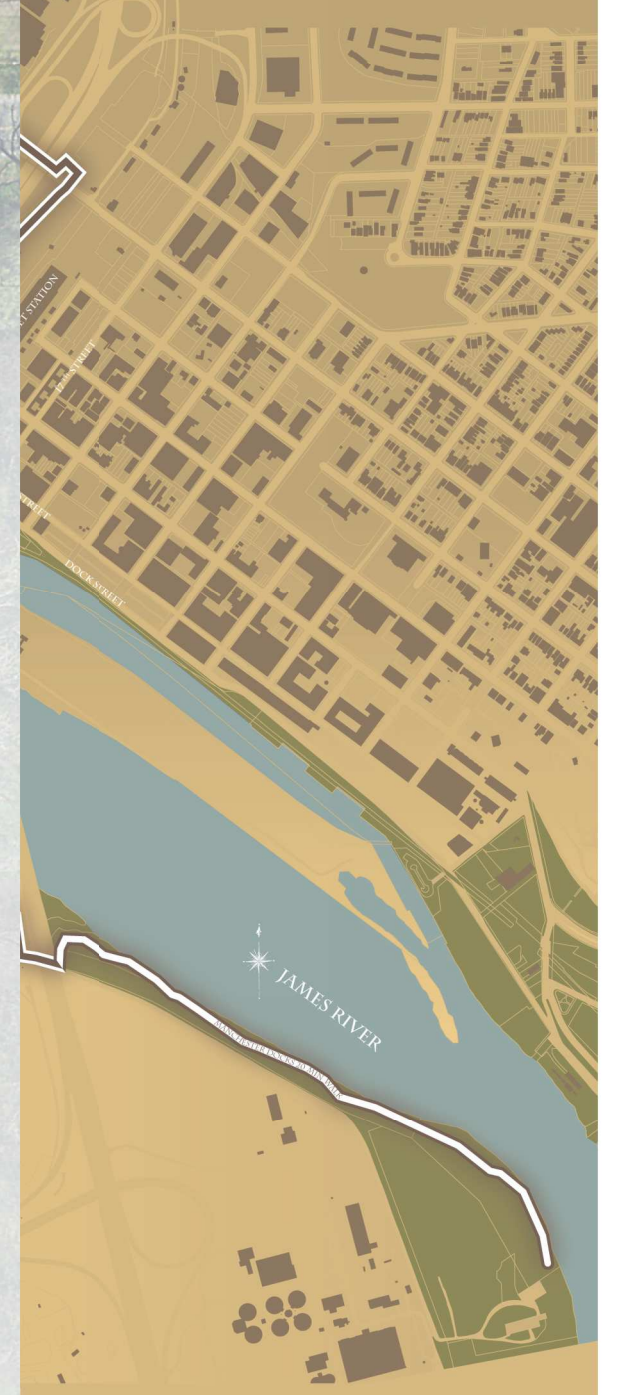

**floodwall enclosure route 1**  
Provide 8'-0" designated bike and pedestrian lane on Brander Street adjacent to a 2'-0" painted buffer to separate new lane markings from vehicular travel lanes.

existing



proposed

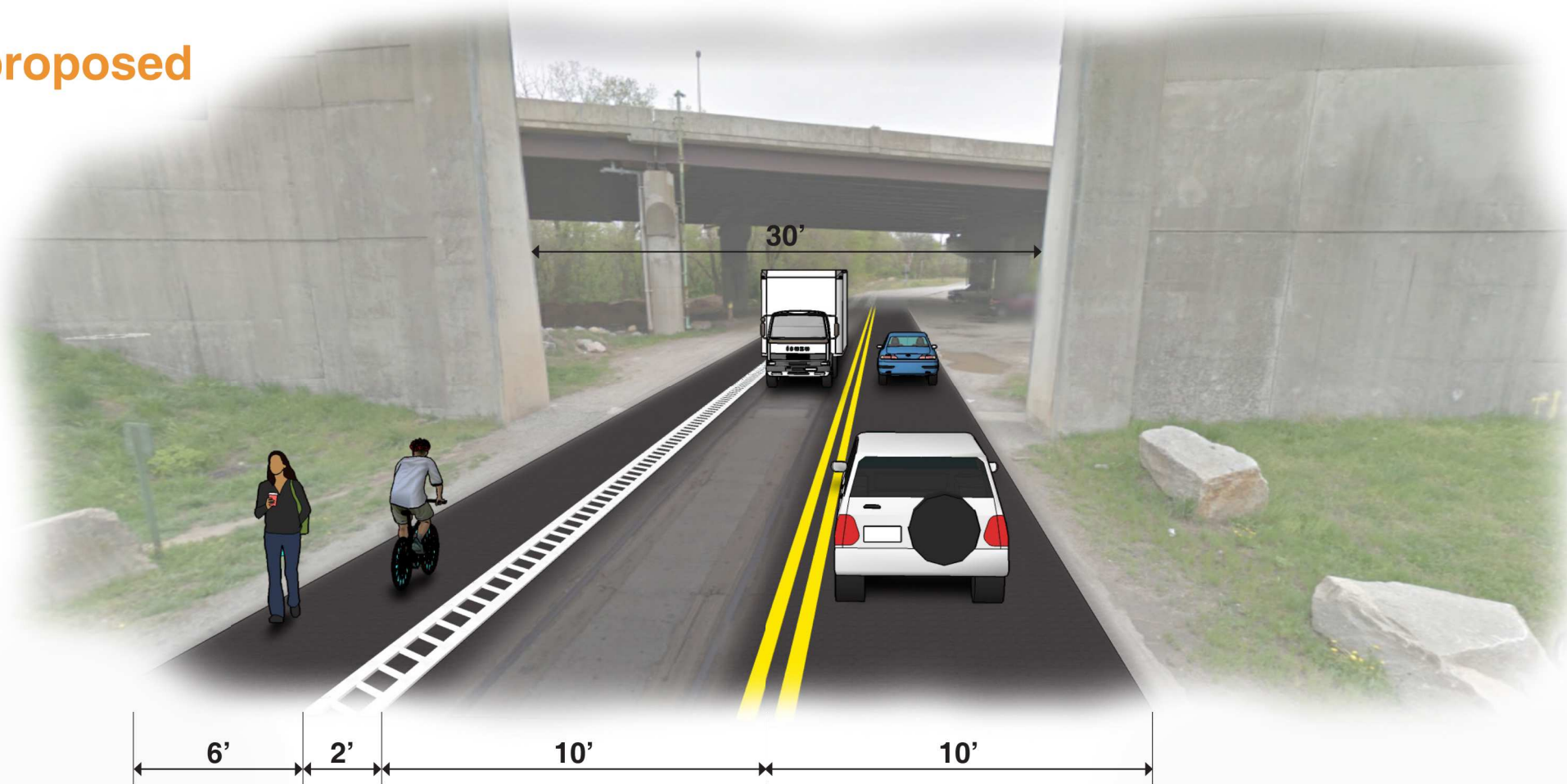

A vertical graphic on the right side of the page. At the top is a historical illustration of a slave auction. Below it is the text "Richmond SLAVE TRAIL" in a serif font, with "SLAVE TRAIL" in a larger, bold font. Underneath is "2019 Proposed Improvements". Below this is a map of Richmond, Virginia, showing the James River and the Slave Trail route highlighted in white. At the bottom are three logos: a small illustration of a group of people, the "vhb" logo, and the "Baskervill" logo.

## guardrail option wooden fencing

traditional appearance  
structurally sound  
easy repair  
approx. \$25 / lf

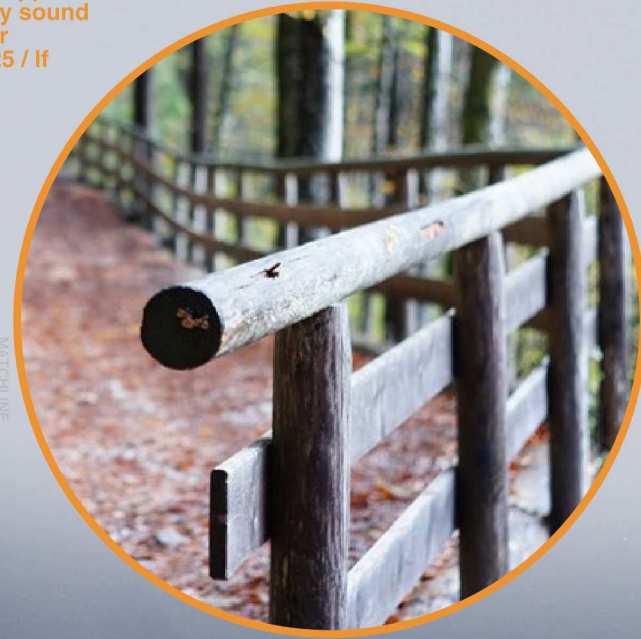

## surfacing option natural trail w/ wood mulch

natural rustic appearance and feel  
approx. \$20-\$25 per cubic yard

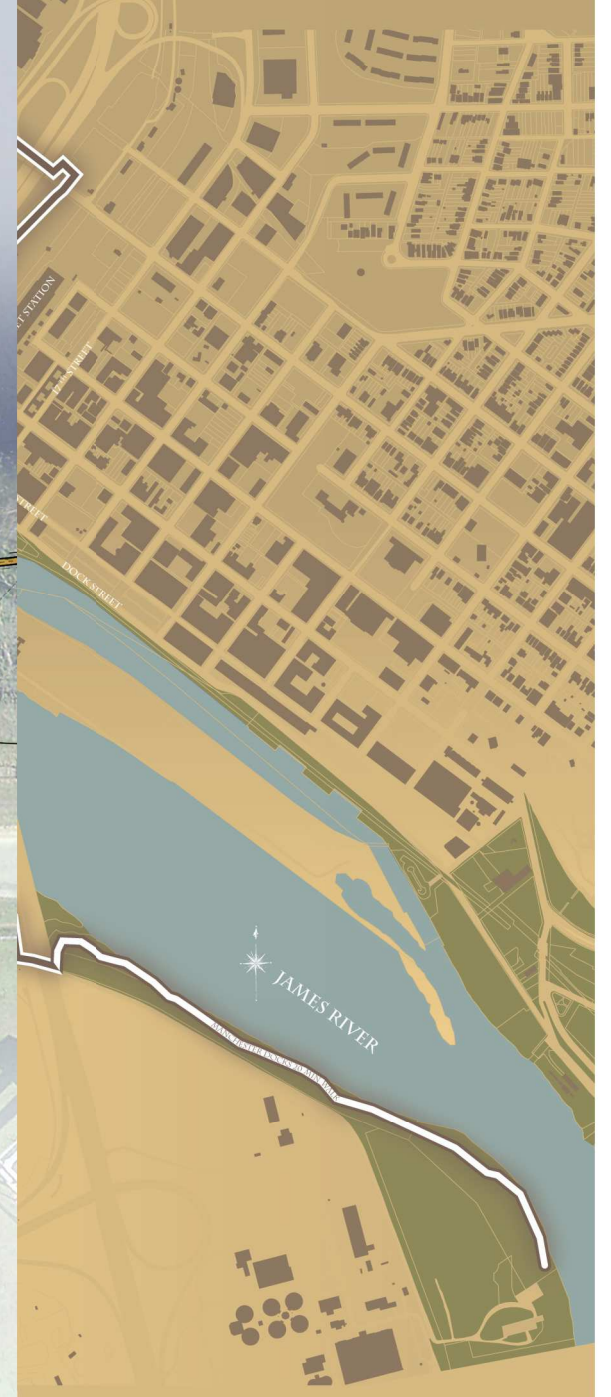

# Richmond SLAVE TRAIL

2019 Proposed Improvements

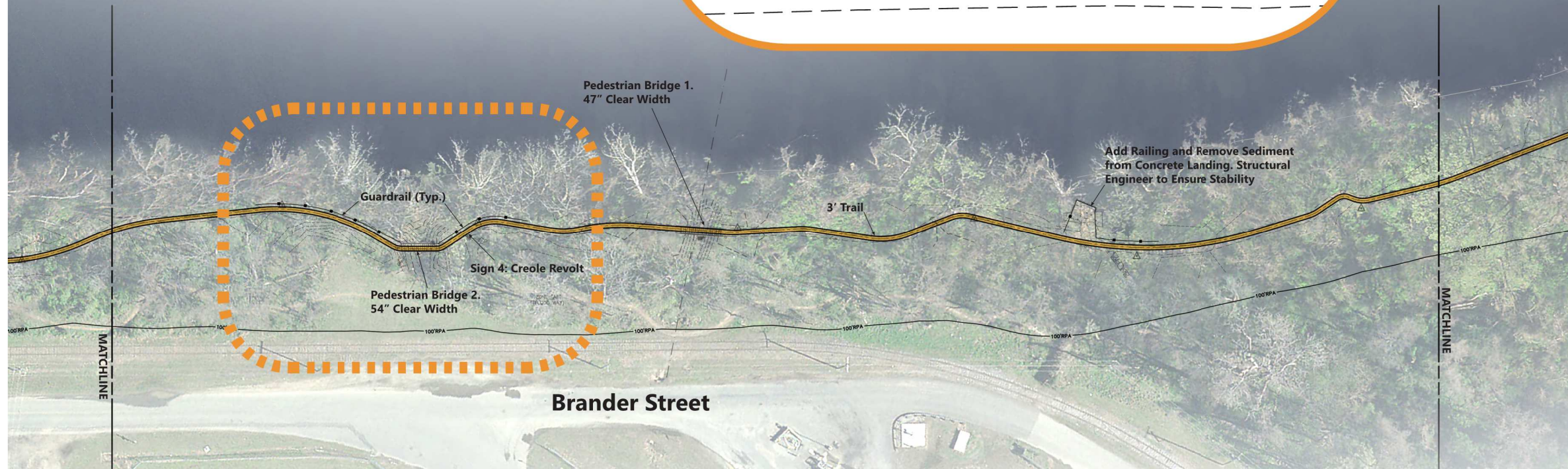
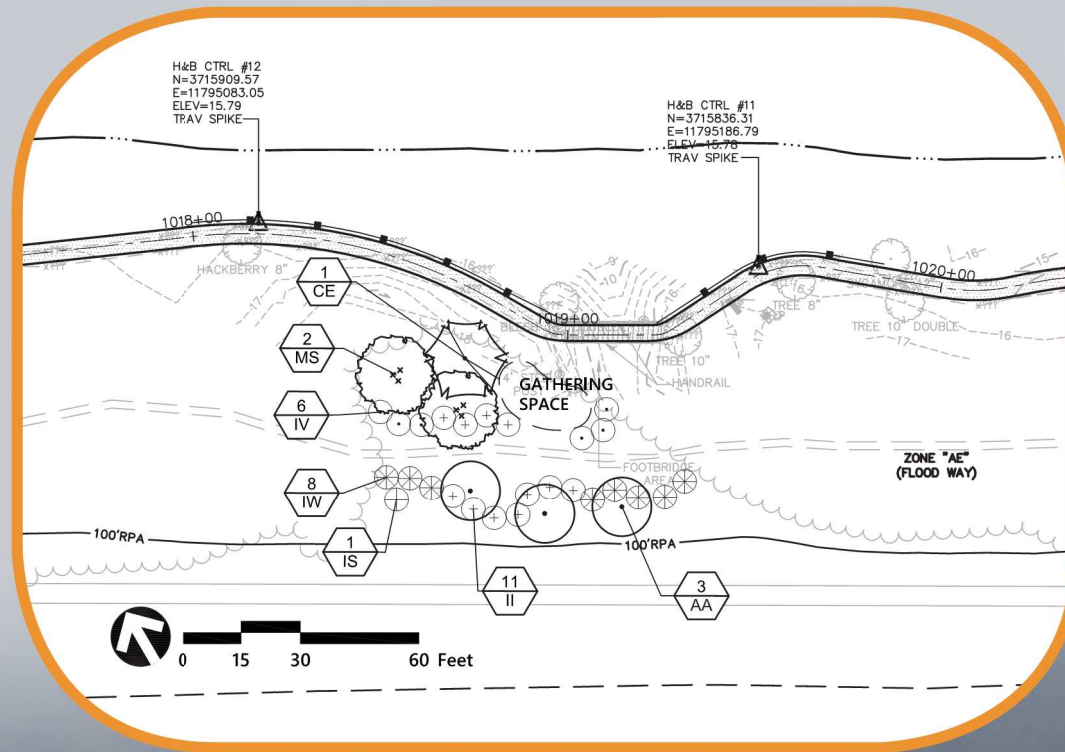

## PLANT SCHEDULE

TREES	QTY	BOTANICAL NAME	COMMON NAME	CONT	CAL	SIZE	REMARKS
AA	3	<i>Acer x freemanii</i> 'Armstrong'	Armstrong Freeman Maple	B & B	2.5"Cal		
CE	1	<i>Cercis canadensis</i>	Eastern Redbud Multi-trunk	B & B		6'-8' HT.	
MS	2	<i>Magnolia virginiana</i>	Sweet Bay	B & B		8'-10' HT	Multi-stem
SHRUBS	QTY	BOTANICAL NAME	COMMON NAME	SIZE			REMARKS
II	11	<i>Ilex glabra</i> 'Compacta'	Compact Inkberry	5 GAL / 24" HT			
IS	1	<i>Ilex verticillata</i> 'Southern Gentleman'	Southern Gentleman Winterberry Holly	5 GAL / 24" HT			
IW	8	<i>Ilex verticillata</i> 'Winter Red'	Winter Red Holly	5 GAL / 24" HT			
IV	6	<i>Itea virginica</i> 'Henry's Garnet'	Henry's Garnet Sweetspire	5 GAL / 24" HT			

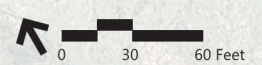
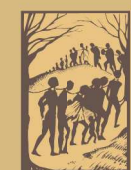
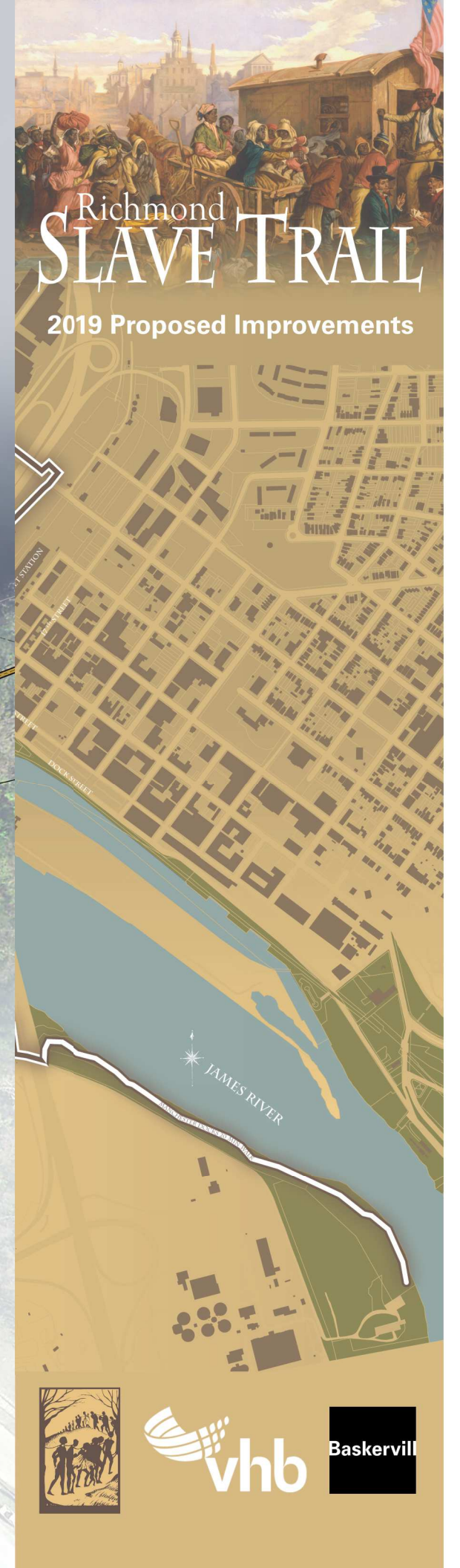

## Ancarrow's Trailhead ship

New trailhead based on slave ship dimensions. Amphitheater seating in ship's wake retained by ballast filled gabion cages and weathered steel site walls. Arrival signage and experiential displays mount to site and entry walls at wood-like entry gangplank. Recessed path lighting and tall solar LED bollard ribs backlight the granite stone memorial within. Two weathered steel 'masts' provide space for additional symbolism, storytelling and wayfinding.

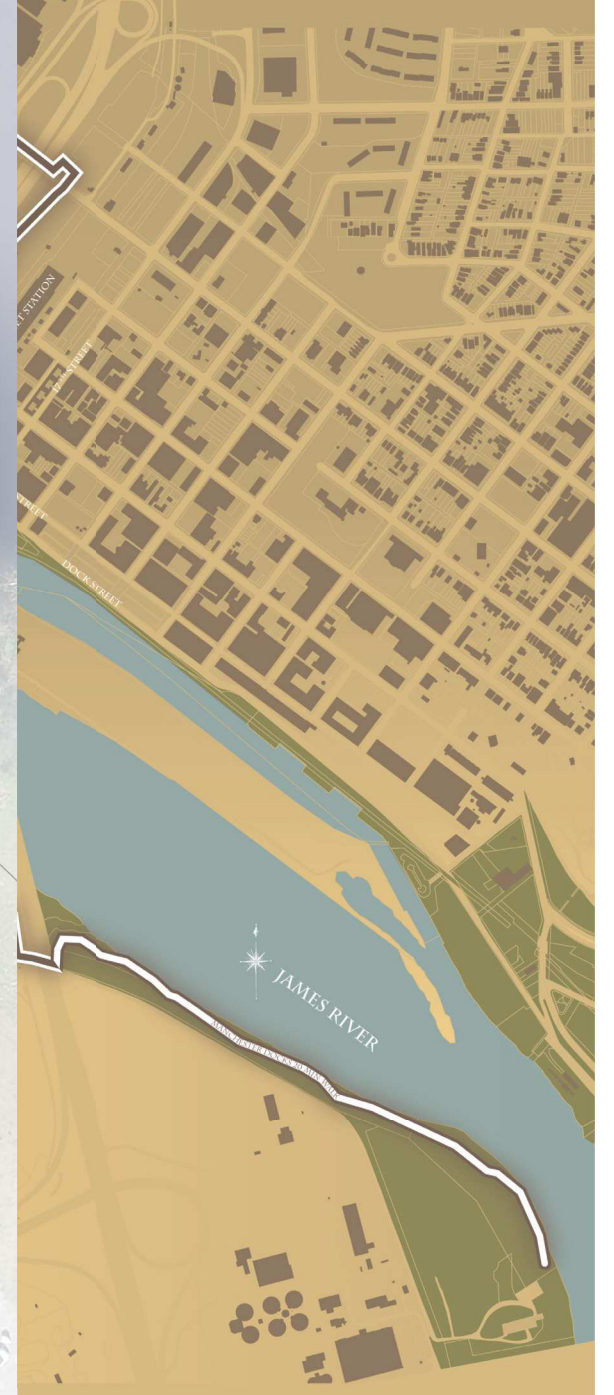
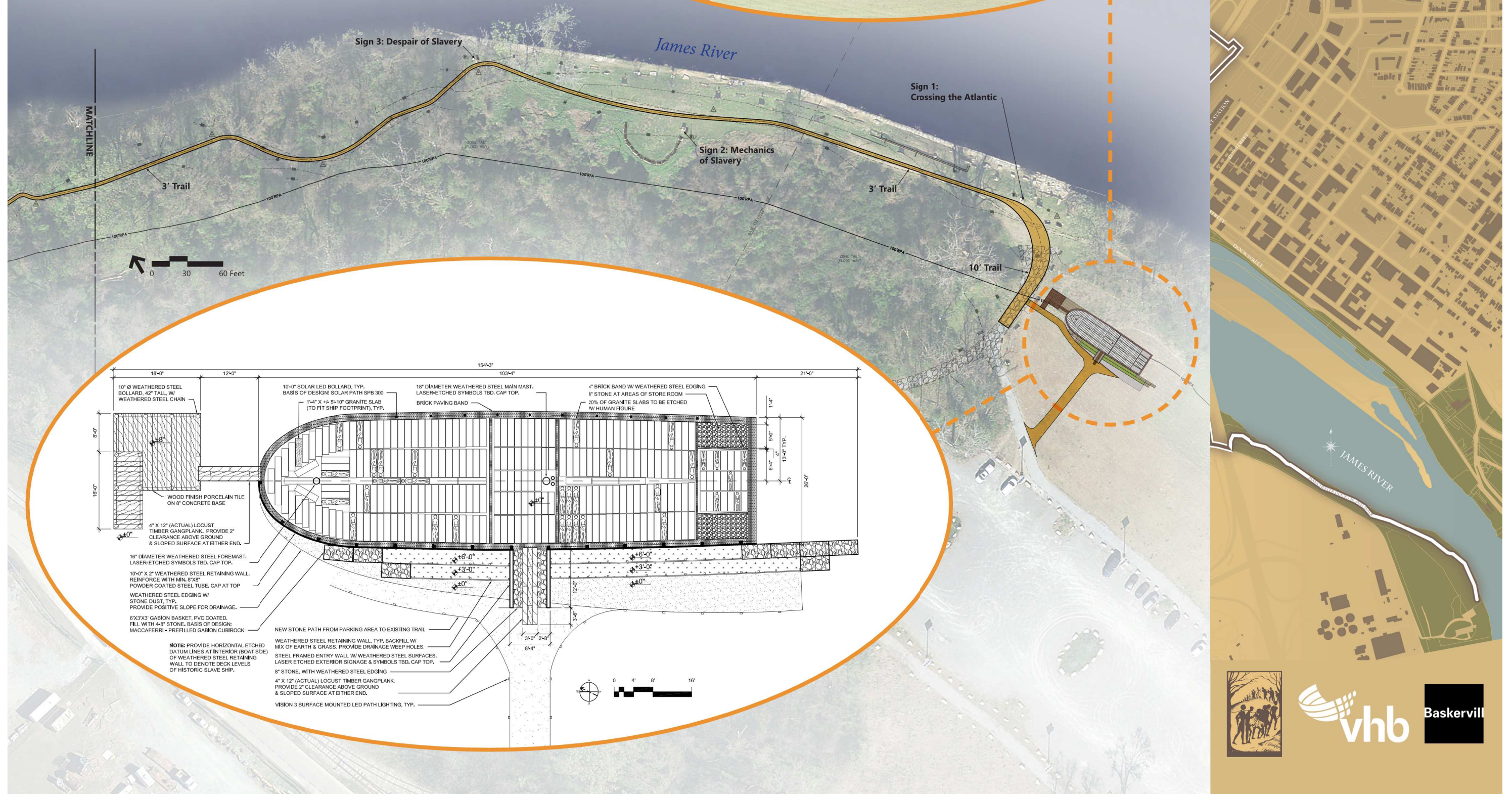
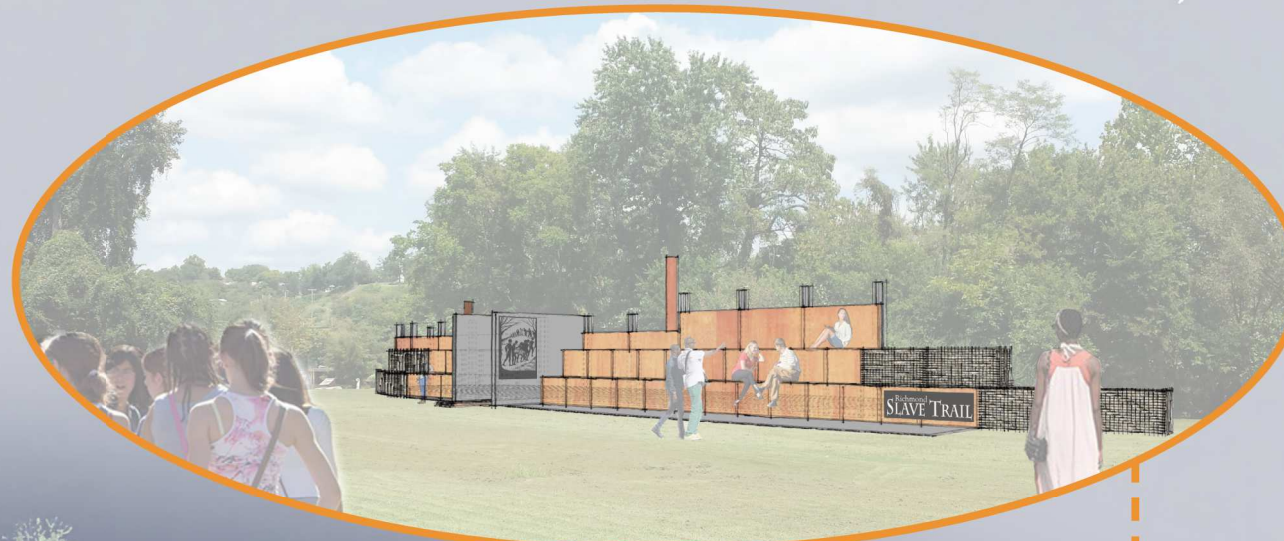

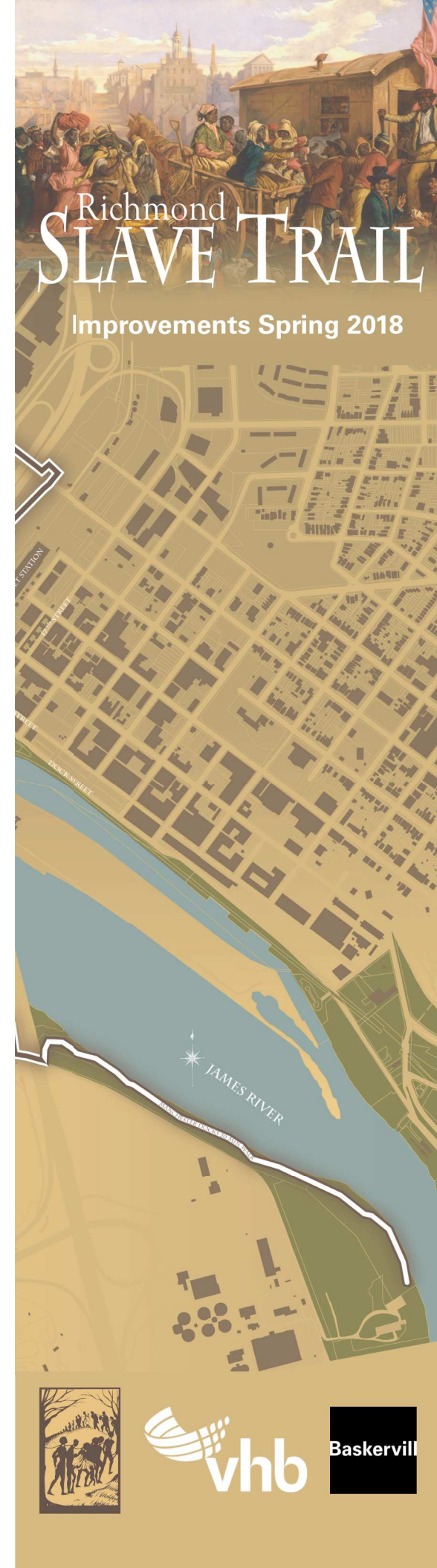
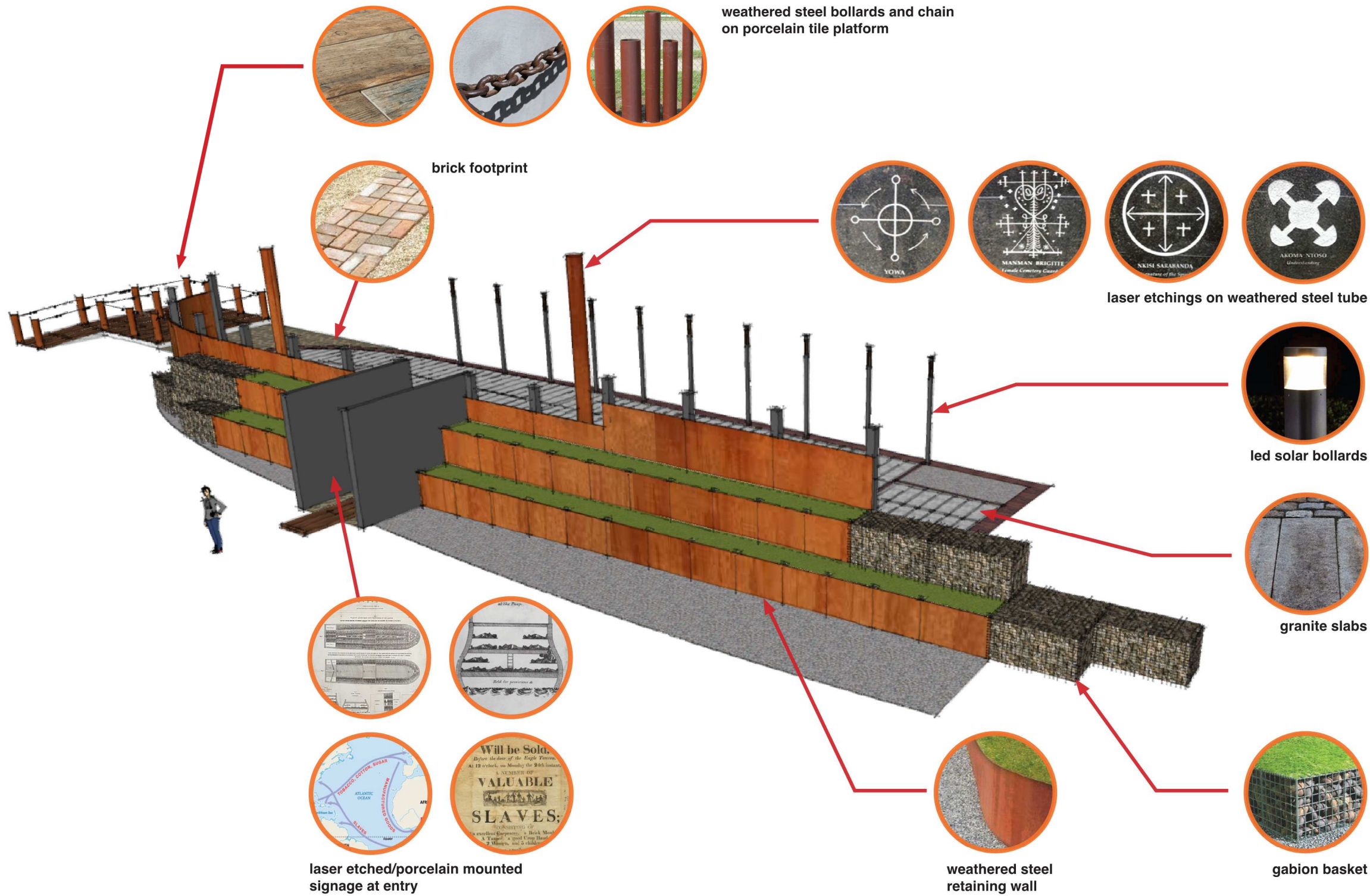

**Ancharrow's Trailhead  
ship**





# proposed new lighting

**PA7**  
PARH/STEP-12V

12V • 50W MR16 • 10W LED

**FEATURES**

- 11 degree 1/2° beam spread provides efficient, even distribution of light. In many installations, lower output lamps can be utilized for reduced energy costs.
- Cover capable so that glare can be better controlled and/or reduced in steps and for foot-candle alignment.
- 1/2" LED driver, wide temperature range and feature redurable lenses.
- LED driver uses dynamic transformer regulation to match voltage and provide LED driver thermal management to keep LED driver at the optimum temperature.

**CONSTRUCTION**

**Material:** Available in cast brass, Stainless steel, or aluminum.

**Cover Styles:** Choice of two cover styles for larger or smaller light distribution. Can also be used without cover for larger fixtures or track light applications.

**Lamp:** MR16 halogen lamp up to 50W, 12V LED module with integral driver and a height eye seal for selection of 20 foot or 20' 1/2" height required input.

**Finishes:** 14 standard powder coat finishes or 2 bronze finishes available. See FINISHES section of catalog, more book come.

**Mounting:** Standard 1/2" track rail brass base plate with anchor bolt holes for surface mounting. Optional PVC ground stake is also available for easy installation into soft soils.

**Certification:** CE, ENEC and created to US and Canadian safety standards for use in wet locations.

All fixtures and lamps subject to change without notice. See web site for detailed V.O. for most current data.

**APPLICATIONS**  
Landscape

**VISION3 LIGHTING**

**LightDeco series**

**SolaTile II**

**Uses and Applications:**

- Shopping • Parks • Parks
- Landscaping • Courtyards • Entrances
- Food decks • Walkways • Building exteriors
- Food bottoms • Beachwalks • And many more.

**SolaTile II Technical Specifications**

Light Output: 4000 lumens  
Beam Spread: 120°  
Power: 10W  
Voltage: 12V  
Height: 1.5" (38mm)

www.solatiles.com

**LED AREA LIGHT**

**GAMA-T Series**

60W-110W

**FEATURES & BENEFITS**

- Pole mounted solar LED area light
- 11 degree 1/2° beam spread provides efficient, even distribution of light.
- 1/2" LED driver, wide temperature range and feature redurable lenses.
- LED driver uses dynamic transformer regulation to match voltage and provide LED driver thermal management to keep LED driver at the optimum temperature.

**CERTIFICATIONS**

CE, ENEC, and created to US and Canadian safety standards for use in wet locations.

**TECHNICAL PARAMETERS**

Parameter	Value
Power	60-110W
Beam Spread	120°
Height	1.5" (38mm)
Voltage	12V
Light Output	4000 lumens
Beam Spread	120°
Material	Cast Brass
Finish	Black or Bronze
Mounting	1/2" Track Rail
Applications	Landscape, Parks, Entrances

**ORDERING INFORMATION**

Quantity	Part Number	Price
10	PA7-10	\$1000.00
20	PA7-20	\$2000.00
50	PA7-50	\$5000.00
100	PA7-100	\$10000.00

# path lighting

Surface mounted solar leds along path. Solar panels at Brander Street power lights remotely.

# area lighting

Pole mounted solar led for Entry Portal Option 2 Ship

**SolarPath sun solutions**

**SPB400 Intelligent Solar LED Bollard**

The SPB400 solar powered LED bollard is an architectural independent lighting solution ideal for various applications in parks, pathways, hotel areas, transit areas, golf courses, beach resorts, marina's, residential areas and landscape lighting projects.

**Technical Specifications**

Power: 40W  
Voltage: 12V  
Height: 4.5" (114mm)

**Users and Applications Guide**

- Parks
- Beaches
- Marina's
- Landscaping
- Golf courses
- Hotels
- Beach resorts

**SolarPath sun solutions**

**SPCASE**

**Solar Lighting On Demand**

**Smart Solar LED showcases**

SPCASE is an independent architectural LED showcase solution which is used in various applications such as promotion points in shopping, parks, museums, universities, pathways, tennis areas, golf courses, transit parks, beach resorts, marina's, and residential areas. It is based on the ecological principle: it only lights up when someone is present. In standby mode, the showcase is off, or will light up at a lower power intensity. An optional charged system battery, powered by and wireless on the showcase at full light level.

**Technical Specifications**

Power: 20W  
Voltage: 12V  
Height: 4.5" (114mm)

**Users and Applications Guide**

- Parks
- Beaches
- Marina's
- Landscaping
- Golf courses
- Hotels
- Beach resorts



# pole lighting

Pole mounted solar led for Entry Portal Option 2 Ship. Can be integrated with display panels.

# Richmond SLAVE TRAIL

Improvements Spring 2018

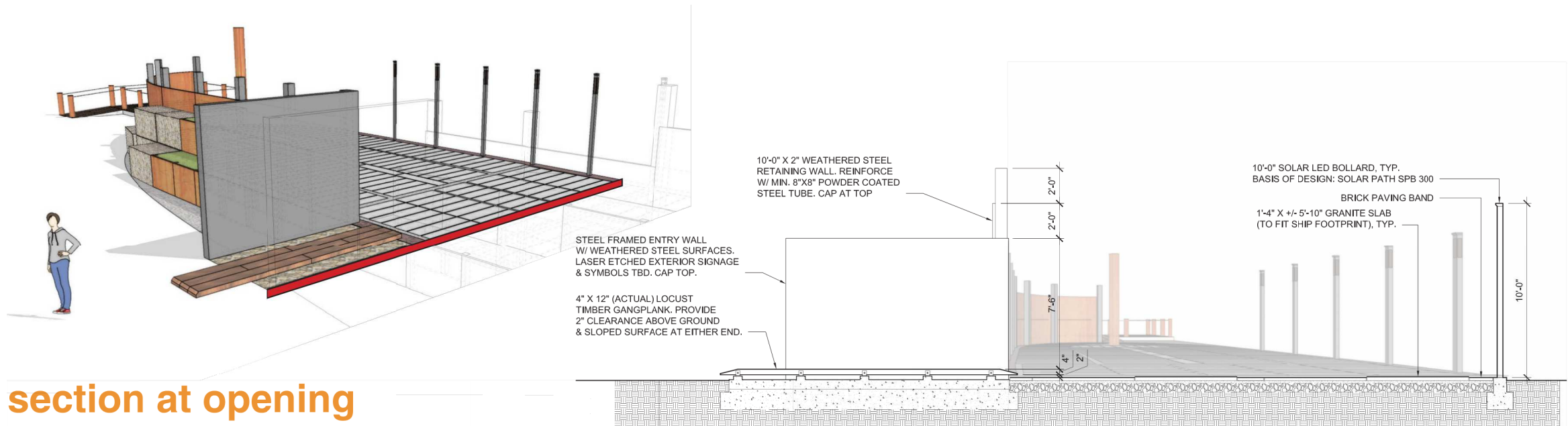
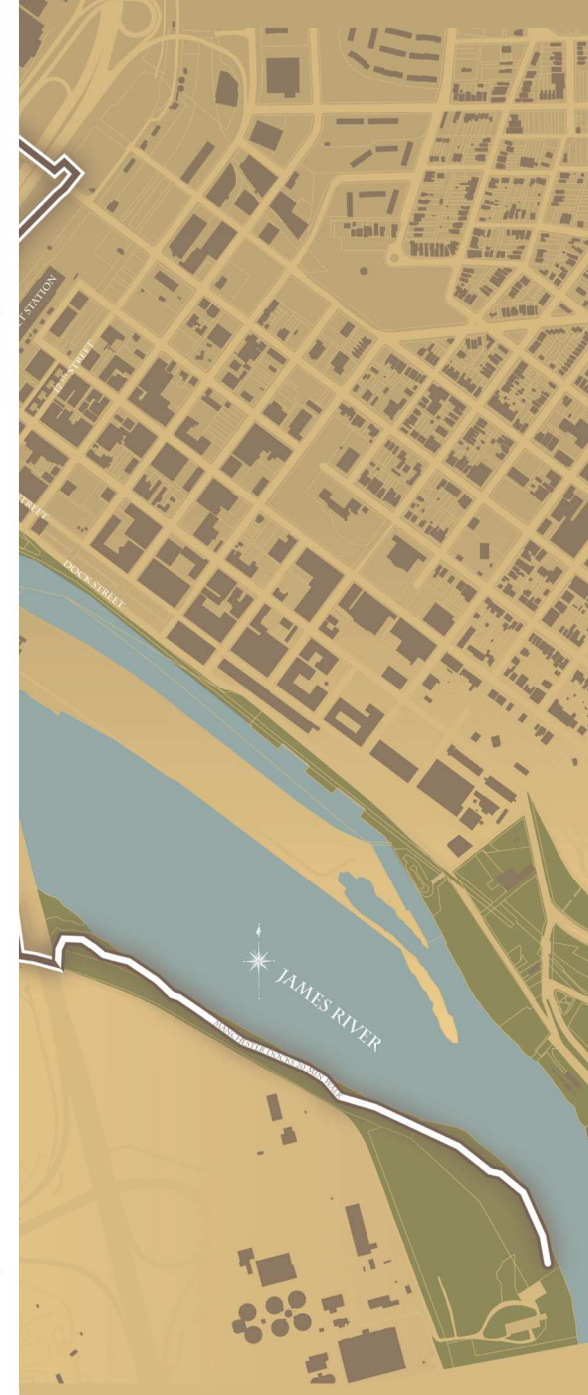

section at opening

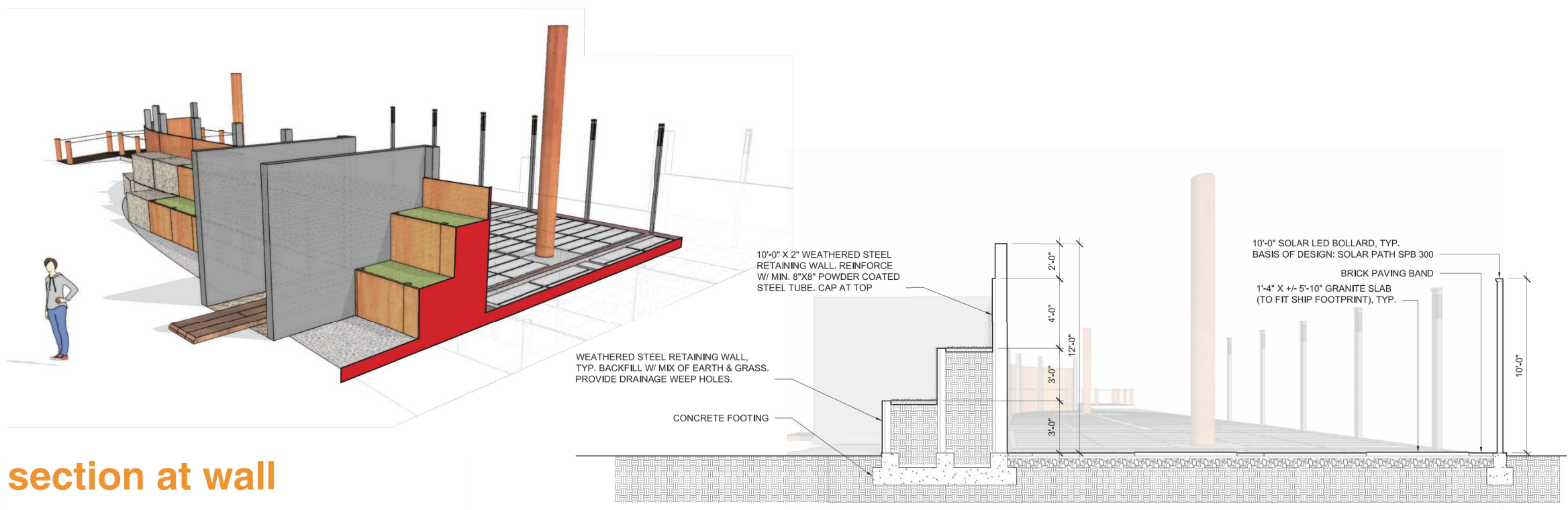

section at wall





Richmond  
**SLAVE TRAIL**  
Improvements Spring 2018

JAMES RIVER

vhb

Baskerville