



Department of Public Utilities

Sanitary Sewer Replacement Work – Chimborazo Drop Shaft Phase I

Project Information

The Chimborazo Drop Shaft and Sanitary Sewer Rehabilitation Phase I project includes the replacement of the portion of sewer that runs from the top of Chimborazo Hill to the bottom of the hillside in the abandoned railroad bed. This project is a permanent replacement for the emergency repaired portion of the brick step sewer that was damaged during the 2004 slope failure caused by Tropical Storm Gaston and has been designed in such a way to avoid potentially unstable soils. The slope between E. Grace Street and the abandoned railroad bed has failed multiple times since the construction of the rail spur. Most recently, the slope failed during the heavy rainfall event of Tropical Storm Gaston in 2004 and again in 2017. As a result of that storm, much of the hill surrounding Chimborazo Park in the Church Hill area became unstable. The large amount of precipitation received during the storm increased the hydrostatic ground water pressure which eventually triggered slope failure. Emergency sewer repair work was done in 2005 and again in 2017 as temporary solutions to put the Chimborazo interceptor sewer back in service after the collapse and damage caused by the storms. The work will be completed over the course of two years.

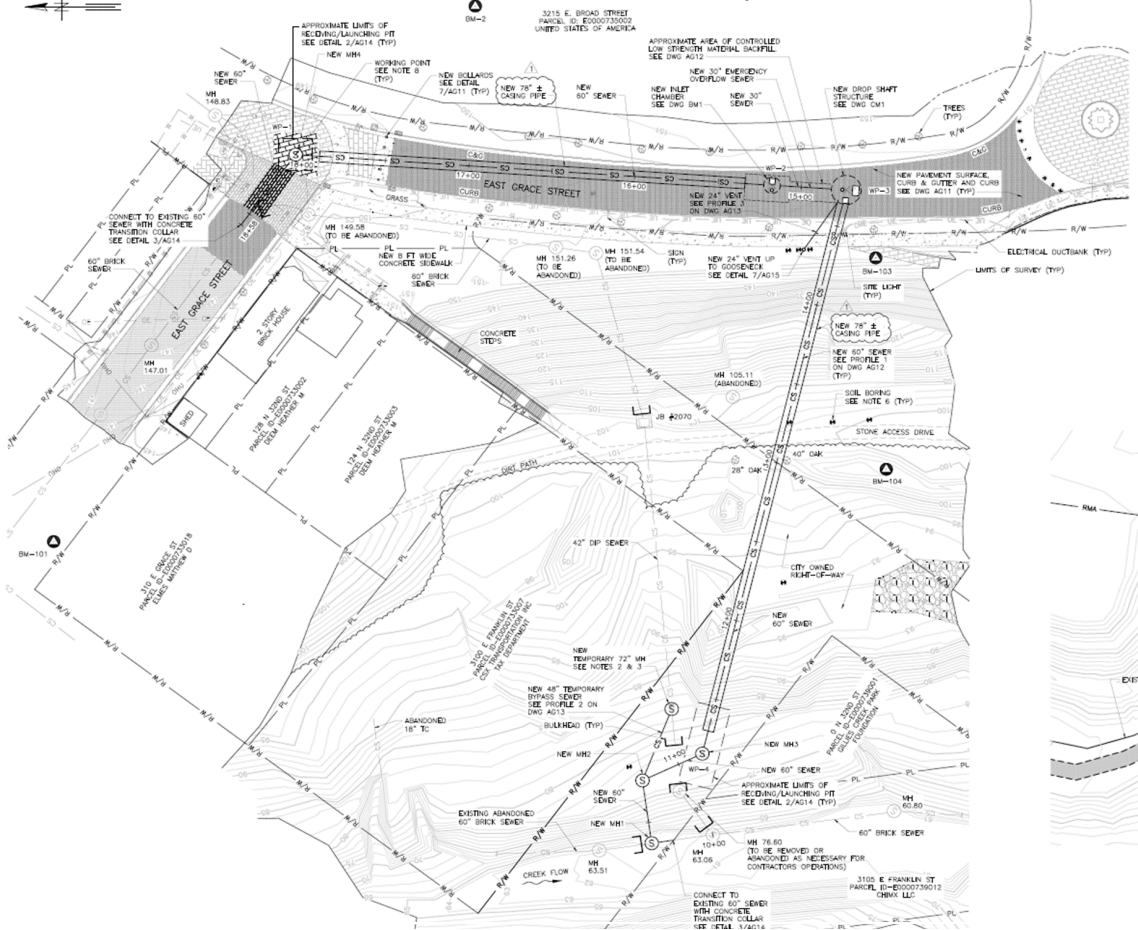

Current Status

The intersection of N. 32nd and E. Grace Streets will require closure for approximately 10 months. Work will include preparing the project area with appropriate safety barriers and removal of pavers, then continue with excavating the receiving pit, boring the tunnel and installing the 60” sewer. Final work will include building the new manhole at the intersection, excavating and tying the new sewer to the existing sewer on Grace Street.

Project Schedule

This work began in July 2022 and is anticipated to continue for two years, barring any weather delays or other unforeseen circumstances.

Phase 1	Currently under construction	E. Grace Street and N. 32nd Street
Phase 2	In design; RFP anticipated Fall 2024	S. 31 st Street and Williamsburg Avenue
Phase 3	Construction out for bid: Review to begin Spring 2023	Williamsburg Avenue to Gillies Creek

Sewer Replacement FAQs

What is the purpose of the project?

This projects consists of constructing a new 10-foot internal diameter inlet chamber manhole and a new 18-foot internal diameter drop shaft chamber located at the top of the existing slope in E. Grace St. The depths of the inlet chamber and drop shaft chamber wall will be approximately 35 and 100 feet, respectively, below ground surface. The drop shaft chamber will contain a fabricated siphon drop unit to accommodate the long drop. The line out of the drop shaft under the hill will be bored as opposed to open cut to ensure it is below the soils that may be prone to slides in extreme weather. The line along E. Grace St. will also be bored. Open cuts will be done at the bottom of the hill and in the vicinity of E. Grace and N. 32nd St. The existing 42”, 48”, and 60” sewers that this line is replacing will be abandoned in place with flowable fill.

Currently the contractor is at the phase of the closure of E. Grace and N. 32nd St. to begin the excavation for the boring pit.

How will this project affect my daily travels and how will I be notified?

Our goal is to minimize the impact on residents to the extent possible. The intersection of N 32nd Street at E. Grace Street, on the east side of Richmond National Battlefield Park in Chimborazo will be closed and posted “No Parking” for 10 months. Parking will be closed by the end of the day, Tuesday, February 28. The park is still accessible from entrance streets along E. Broad Street and E. Grace Street is accessible from N. 36th Street. Our goal is to minimize the impact on residents. If there are any impacts, we will notify residents via door hanger notices.

How long will the project take?

This project is scheduled to take two years to complete. This phase of the work is scheduled to last for approximately 10 months. Work will be continuous, Monday - Friday, unless impacted by weather, equipment failure or other unforeseen circumstances.

Will sidewalks be impacted?

The sidewalk on E. Grace St next to the Chimborazo Hospital will be closed for the duration of the project. In most cases, other sidewalks will remain open for pedestrian traffic. If sidewalks or crosswalks need to be closed for public safety, pedestrians will be rerouted to safer pathways of travel. [Other improvements are being considered in this scope of work, to include accessibility ramps and sidewalk repairs, etc.](#)

How will traffic be affected?

The temporary traffic control plans will allow construction to proceed safely while attempting to minimize impacts to the public. When possible, vehicles will be rerouted past any closed travel lanes but some road closures with detours may occur to maintain a safe pedestrian and vehicular travel environment. Road closures will be posted on the Department of Public Utilities street closing Twitter feed (@DPUStreetNews). Every effort will be made to allow access to residences when it's feasible and safe. Variable message boards will be posted at each end of the project to alert vehicles of the changes to thru traffic.

How will parking be impacted?

Please observe and follow directions of "Closed Lanes" and "No Parking" signs around the work zone areas. Parking will be limited for the safety of citizens as well as construction personnel. Any areas of No Parking will be posted at least 48-hours in advance of the work being performed. Please observe and follow directions of "Closed Lanes" and "No Parking" signs around the work zone areas.

What will other impacts be?

There may be some noise as construction vehicles enter and exit the work zone. There will also be some noise and minor vibrations during sheeting and shoring installation to access replacement of deep sewer mains.

If you have questions or comments about this project, please contact the Department of Public Utilities:

Kurt Weishaar PE

Arcadis Senior Resident Engineer
(804) 646 -1400
kurt.weishaar@arcadis.com

Media Contact:

Rhonda Johnson

Public Information Manager, Sr.
(804) 646-5463

Quinton Nottingham

Project Manager, Department of Public Utilities
(804) 646-5365
Quinton.Nottingham@RVA.gov

Rhonda.Johnson@RVA.gov